

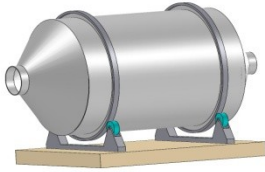

We have two models of Rotary Furnace, one without barrel (Flame Shape) and another with barrel (furnace body). Both designs are advantageous, depending upon requirements.

### **Barrel Type Rotary Furnace**



This is traditional design. Smelters have been using this type of furnace from very olden days around the world. But the final product is MIXED Lead (DOGALA Lead) and the recovery is also lesser as compared to our newly designed Rotary furnace. I will explain it in next paragraph. The reason for lesser recovery is clogging of slag into the tap out hole and In this turning process molten lead is mixed with slag and small amount of lead is retraped with slag so recovery is further reduced. So we designed Rotary furnace without barrel.

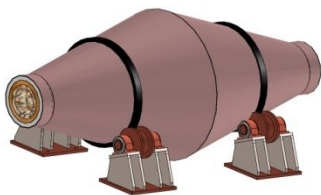

### **Rotary Furnace without Barrel or Flame Shape Rotary Furnace:**

In this type of furnace, following advantages had been practically gained:

1.Barrel type Rotary was designed for Iron Smelting, not for Lead, as we all know, thermal conductivity of Iron is very much different than Lead. Iron thermal conductivity is 80 while Lead thermal conductivity is 35 W/(m K). It considerably reduces with temperature. So, we increased L/D ratio of Furnace. This reduces temp. of exit gases, hence utilisation of energy is increased.