



*Keyword to Safety*



## DOMUS. We believe it, we make it!

What we believe in is what we make. That is why in DOMUS our philosophy is based on three basic disciplines, QUALITY -SAFETY – FUNCTIONALITY. We work within this frame and we will continue to do so in the future.

DOMUS produces more than 500 products. Its business takes place in Greece and abroad, as well as covering every sector of safety. Today DOMUS manages to offer its clients, maximum security combined with aesthetics.

Realizing that quality and development of new products are essential factors of its success, it invests in continuous research in order to offer products that correspond to its consumers' needs.

The company's most important capital is its human resources. Its people are carefully selected for their values and they are the reason the company thrives in today's competitive world.

DOMUS is here today to make the difference and to continue its effort to contribute for a more secure and beautiful world!





## DOMUS CERTIFICATIONS

- Applies a certified quality system **ISO 9001**
- Is following a certified health and safety management system **OHSAS 18001**
- Have a **test lab** of finished products according to European standards
- Uses **high-tech** equipment
- Manages the **suggestions and complaints** of customers
- Aims at **continuous improvement**





## DOMUS FACTORY in GREECE

100 years of history!





# Security Mortise Lock

- Single turn -17mm- dead bolt
- The most famous product of DOMUS
- Adjustable upper latch
- Available at: 20, 25, 30 & 35mm backset



Code: 90120C, 91125C, 91130C, 91135C

*5 years warranty*





## Double Turn Lock

New

- Lock with Two key turns
- Two hardened steel pins in the dead bolt
- Long dead bolt, **24mm**
- Adjustable upper latch
- INOX face plate
- 30mm backset



Code: 91330XE

*5 years warranty*





## Falling Latch Lock

- Long falling latch dead bolt, **25mm**
- Adjustable upper latch
- Offers maximum security
- Available at: 30mm & 35mm backset



Code: 91430E & 91435E

*5 years warranty*





# Roller Lock

- For swung doors without handles
- 17mm dead bolt with a single throw
- Available at: 20, 25, 30 & 35mm backset

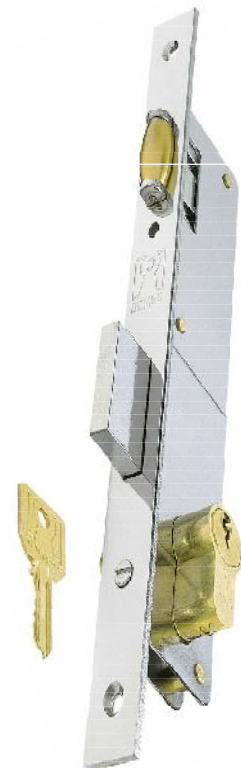

Code: 92120C, 92125C, 92130C, 92135C

*5 years warranty*







## INOX Locks

- Available for all the sizes of Mortise Locks, Roller locks & Falling Latch Locks
- INOX AISI 304
- Ideal for areas with humid climate or close to the sea



Code: .....XC

*5 years warranty*





## 3 Locking Point Lock

- 3 locks with falling latch deadbolts
- Long falling latch dead bolts, **25mm**
- Offers extra security
- Available at: 30mm & 35mm backset
- Available also in INOX AISI 304



Code: 94430E & 94435E

*5 years warranty*





## 3 Locking Points Lock TOP GEAR

- Steel system of gears and cogwheels
- Freezing of the upper and lower latch in case of violation
- 35mm backset
- *Double turn lock*
- 20mm long latches for maximum security

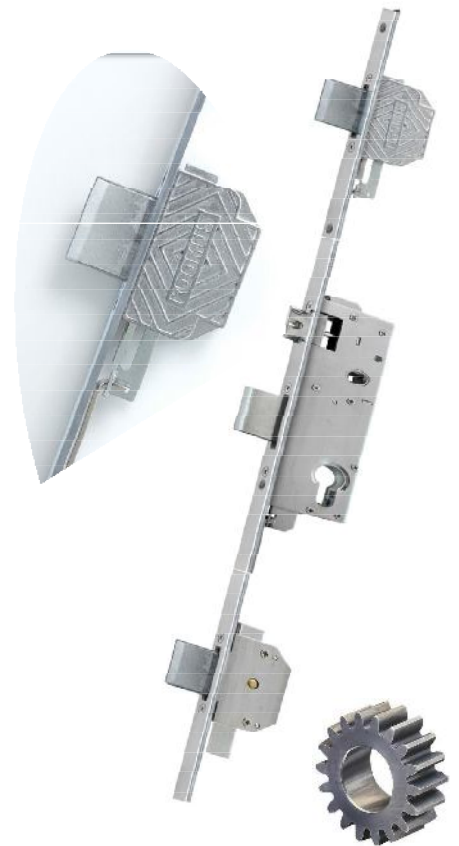

Code: 93635E

*5 years warranty*





## 5 Locking Points Lock TOP GEAR 5

New

- Steel system of **gears and cogwheels**
- It has a combination of two 'roller' and 'mushroom' locking points for sealing and safety
- Easily fixed, without new holes on the profile
- Increases Thermal and Acoustic Insulation
- 35mm backset
- *Double turn lock*



Code: 94635E

*5 years warranty*





## Electric Door Opener (simple)

2 types of Electric door opener:

1. For an economic solution: Standard (9901E)
2. With Permanent Release Mechanism (9902E).



*5 years warranty*





## Electric Door Opener (adjustable)

2 types of Electric door opener (adjustable):

1. With Permanent Release Mechanism, Adjustable (9901FE).
2. With Permanent Release and Delayed Action Mechanism, Adjustable (9904FE).



*5 years warranty*





## Classic Handles

- Metallic base with **4 fixing screws** for high stability
- **Allen key mechanism** applied on the base for extra stability.
- **Depth 29mm** of the metallic bar for small and big profiles adjustment.
- Turning metallic cup.
- In more than 300 special colors, plus chrome finish.
- Available in Normal and Oval shape, with or without escutcheons.



- Oval shape Code: 6150LE & 6160LE
- Normal shape Code: 6110LE & 6120LE

*5 years warranty*





New

## NEW Handles

- With turning cap for easy installation
- Finger touch at the bottom side of the handle for better sense of touching
- Available in Black and White color, set with or without escutcheon
- Very competitive price
  - With Escutcheon Codes: 6310LE & 6310ME
  - Without Escutcheon Codes: 6321LE & 6321LE



*5 years warranty*







## Plate Handle



- **Allen key method** applied on the base for extra stability.
- In more than 300 special colors, plus chrome finish.
- Suitable for left or right installation without modifications.

• Code:61450LE

*5 years warranty*





## INOX Handle

- Made of Stainless steel **AISI 304**
- Suitable for all aluminium and wooden doors
- Very easy installation



- Code:6200XE

*5 years warranty*





## Security Escutcheon

- For burglar proof cylinder protection
- Outer escutcheon made of hardened steel (58-63 HR)
- INOX (AISI 304) inner decorative escutcheon
- Protection from drilling, sawing, hammering
- Disassembling only from the inner side



- Code:20033NE

*5 years warranty*





## Kliklock sliding Lock

- Locking bolt with Steel Hook.
- Ideal for sliding aluminium profiles from 28 to 42 mm.
- With electrostatic paint finish for durability and protection. Following **ISO 9001** certifications and the **Qualicoat**.
- Available in 4 colors: White, Black, Brown & Silver
- Available:
  1. With (7710LE) or Without cylinder (7610LE)
  2. With single flush handle and with supporting fittings (7610LC)



*5 years warranty*





## Hook Bolt sliding Lock

- Designed for extra security.
- Suitable for steel and aluminium sliding doors
- 95030: 30mm, Accompanied with any DOMUS cylinder.
- 95016: 16mm, included an oval cylinder with nickel finish.



*5 years warranty*





## CREMON for opening windows

- In more than 300 special colors, plus chrome finish.
- Stainless steel security plate and screws.
- Easily reversible for right or left frames.



Oval shape (6950LE) & Normal shape (6900LE)

*5 years warranty*





## Tilt and Turn Mechanism PRO 20

- 4 locking points.
- There are parts from Stainless steel and Graphite plastic for durability.
- With adjustable metal locking sliding latches.
- The parts of the mechanism are assembled
- Packed in only two boxes

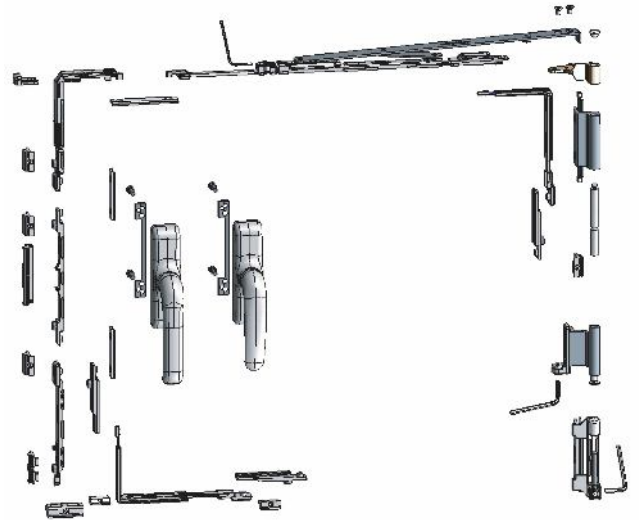

- Oval shape: 65150LE & 65141E
- Normal shape: 65100LE & 65150LE

*5 years warranty*





## Standard Sliding Latches

- Extra strength because of the plastic parts made of special Polyamide material.
- Suitable for Left or Right handed windows.
- Very easy to install it.
- The safest solution for double aluminium frames.

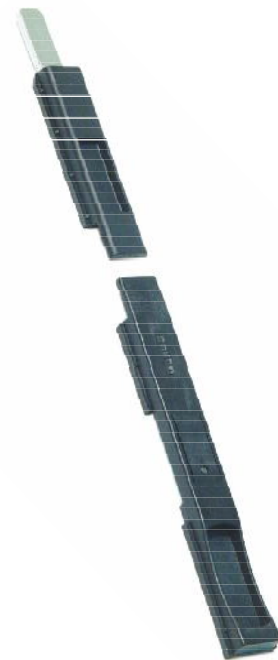

Code: 6590E

*5 years warranty*







## Metallic Sliding Latches

- With metallic locking slides with adjustable ends.
- Maximum durability with the simultaneous top and bottom locking with a single motion.
- Suitable for Left or Right handed windows.
- Very easy to install it.
- The safest solution for double aluminium frames.



Code: 6595E

*5 years warranty*





## Standard Cylinders

- NICKEL finish.
- Five combination pins in both sides.
- Available in 9 dimensions.
- 3 keys are included.



*5 years warranty*





## ECON security Cylinders

- NICKEL finish.
- Available in 4 dimensions.
- 5 flat nickeled keys are included.



*5 years warranty*





## ALFA (high) security Cylinders

- Nine combination pins with hardened steel pins.
- Extra Security as the cam stays 150 off line.
- NICKEL finish.
- Available in 4 dimensions.
- 5 flat nickeled keys are included



*5 years warranty*





## PROTON (PREMIUM) security Cylinders

- Along with a **Special Owner's Card**.
- Nine combination pins with hardened steel pins.
- Extra Security as the cam stays 150 off line.
- 5 flat silver- nickered keys are included
- Available in 62mm & 75mm.



*5 years warranty*





## Knob Cylinders

- Oval and Round shape.
- NICKEL finish.
- 3 nickel keys are included.
- Assembled on all cylinders and on both sides.



*5 years warranty*





**- THANK YOU FOR YOUR TIME -**

**FOR FURTHER INFORMATION PLEASE CONTACT US AT:**

TEL: 0030 210 4936202 Int. 126  
FAX: 0030 210 4917247  
E-mail: [export@domus.gr](mailto:export@domus.gr)

We hope that we can satisfy the most of your needs and add value to your business  
with our wide product range.

*5 years warranty*

