

mWRAPR Saliva DNA/RNA Collection Tube

azooka

INTENDED USE

The mWRAPR Saliva DNA/RNA Collection Tube is a user-friendly saliva collection kit for stabilizing the nucleic acid content of saliva and sputum samples.

SUMMARY AND EXPLANATION

mWRAPR Saliva DNA/RNA Collection Tube is designed for the efficient collection, stabilization, and transport of saliva samples while preserving both microbial and host genomic material at ambient temperature. The proprietary stabilization solution is free of cross-linking agents and nucleic acid-modifying substances, ensuring the integrity of genetic material for downstream applications such as molecular diagnostics and genomics.

Samples stored in these Saliva Collection Tubes are stable at ambient temperature, and can be frozen for longer-term storage.

PRODUCT FEATURES

- Accurate & reproducible DNA/RNA yields for down-stream processing and analysis.
- Stabilizes DNA for up to 30 days at ambient temperature.
- No cold storage required.
- Easy sample processing.
- Zero contamination shelf-life for up to 2 years.

PRECAUTIONS

1. Do not use tubes after expiration date.
2. Product is intended for use as supplied. Do not dilute or add other components to mWRAPR DNA/RNA Saliva Collection Tube.
3. Overfilling or underfilling of tubes will result in an incorrect sample-to-stabilization solution ratio and may lead to incorrect analytic results or poor product performance.

CAUTION

- During operation, always wear a lab coat, disposable gloves, protective goggles and mask.
- All biological specimens and materials coming in contact with them are considered biohazards and should be treated as if capable of transmitting infection.
- Products should be disposed of with infectious medical waste.

DIRECTIONS FOR USE

Pre-Collection Instructions

- Avoid drinking alcohol at least 12 hours before sample collection.
- Avoid eating, drinking, or chewing for at least 45 to 60 minutes before saliva collection.
- Gently rinse your mouth with drinking water to remove residual food particles.

Funnel-based

- Gently spit saliva into the collection tube (with the help of the funnel provided in the kit) containing the preservative solution till the total volume reaches up to 5 mL.
- Remove the funnel and tightly recap the collection tube and thoroughly mix the contents of the tube by inverting the tube.
- Transfer appropriate volume of sample solution into a tube containing lysis solution from any commercially available DNA/RNA isolation kit and follow the manufacturer's instructions.

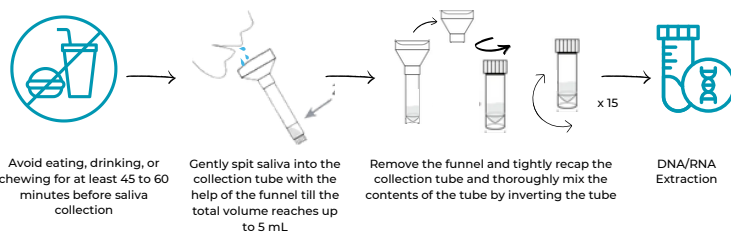

STORAGE AND STABILITY

Temperature	Sample Stability
-20°C and below	Indefinite
4°C	Up to 1 year
Ambient Temperature	Up to 90 days
35-40°C	Up to 90 days
50-65°C	Up to 90 days

- When stored at room temperature, empty mWRAPR Saliva DNA/RNA Collection Tube is stable through expiration date.

LIMITATIONS

1. For single use only.
2. Samples added in other preservatives may cause precipitation in mWRAPR Saliva Collection Tube.

ORDERING INFORMATION

Please call us at +91 8088747968 or mail at hello@azooka.life for any queries or assistance.

Additional information can be found online at www.azooka.life

Cat No. MW-AZ0010

MANUFACTURED AT:

1A, Kushal Garden Arcade, 'C' Block, 5th Floor, Peenya Industrial Area, 2nd Phase, Bengaluru, Karnataka, India- 560058

ISO 13485 CERTIFIED

CE IVDR