



RETRACTABLE

ferco
SHUTTERS & SEATING



INTRODUCTION

INTRODUCTION

With three decades of experience, Ferco's seats have been installed in over 32 countries globally. Having installed the first retractable systems in Singapore in the 1980's, we are specialists in the supply and installation of retractable systems for schools, arenas and entertainment venues.

Ferco's retractable system gives architects, consultants and users the freedom to open up space when required, transforming sporting arenas into multi-purpose halls in a matter of minutes.

With a wide choice of seats installed on a custom built understructure, we provide retractable, fixed or removable seating solutions that encourage freedom of space and multi-functionality.

GUARANTEED PERFORMANCE

Our retractable systems are designed for reliable performance and minimal maintenance over its lifetime. Each system installed is guaranteed to perform with a 10 year warranty for the understructure.

Get in touch with our consultants to configure a system that transforms your space.

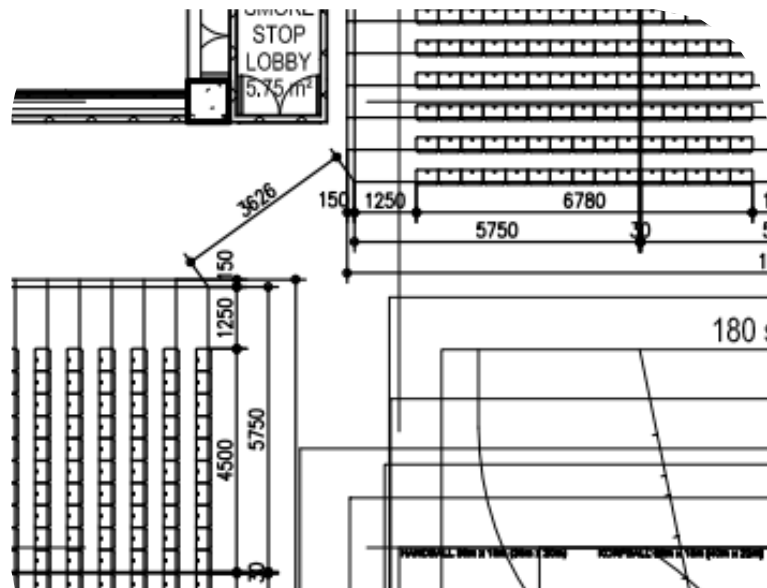

effective space management

safe, strong & reliable systems

easy to install, operate & maintain

configured for various applications

precisely manufactured & customized



ADVANCED FEATURES

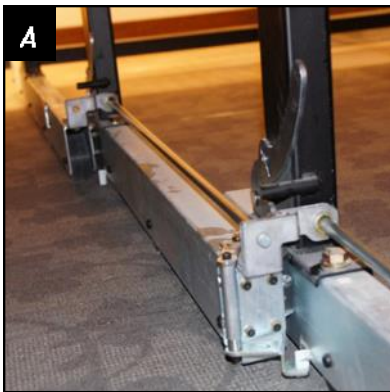

SAFE LOCKING (A)

Safety is of utmost importance when operating a retractable system. With the highest safety standards in mind, our system is constructed with a dual locking mechanism that is activated when both, extending and retracting. Heavy duty spring loaded steel locks safely hold each row in its desired position, and its construction ensures that the mechanism will not bend or fail during operation.



ADJUSTABILITY (B)

Retractable platforms are designed to be used on smooth, hard and level floors. Using double adjustable girders at several points, the system can compensate for minor changes to flooring. This keeps the system running smoothly and quietly over its lifetime.

DURABILITY AND STRENGTH

Using heavy gauge powder-coated (USEPA standards) steel for the understructure, the system is designed to be robust and strong. The deck is made from either 18mm thick plywood sections covered with a durable PVC flooring OR extruded aluminum sections. The decks can be covered with carpeting to suit your hall or non-slip flooring for arenas.

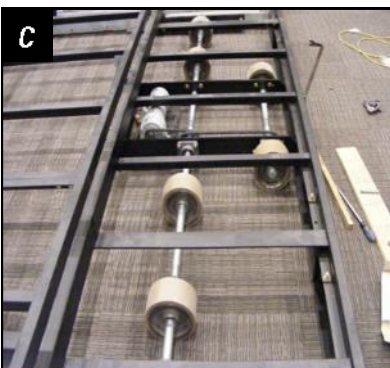

PROTECT YOUR FLOORING (C)

Having tested higher than industry standards, our platforms use wider wheels that are positioned to provide more earthing points. This means a more efficient spread of load. The wheels are covered with polyurethane to reduce the risk of damage to the flooring or carpeting.



TYPE OF SEATS

TIP UP SEATS



TB Series (PAGE 8)

Pictured above: Model TBF



ARC Lite Compact (Page 12)



FCB-M (PAGE 14)

The seats and armrests automatically tilt upwards when people stand up. On retraction of the system, the seats fold down and are neatly tucked away. This seat type provides the maximum amount of walking space for the audience.

FOLD DOWN SEATS



FD Series (PAGE 16)

Pictured above: Model FDF-WW

These seats are a little more economical than tip up seats. The backrest folds down upon retraction of the system. Upon extension, spectators will lift the backrest to an open position.

BENCHES

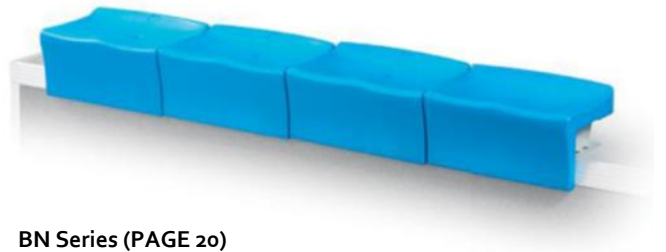

BN Series (PAGE 20)

Pictured above: Model BNP1

Bench type seats provide the easiest maintenance, and provide the most flexibility and seating capacity in small spaces. These benches can be provided with optional backrests.



STORAGE

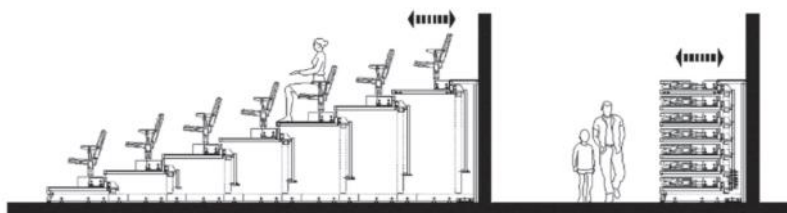

WALL ATTACHED

The last row of the system is either fixed on the floor, behind a wall or both. The system will subsequently extend one deck at a time from the first row.

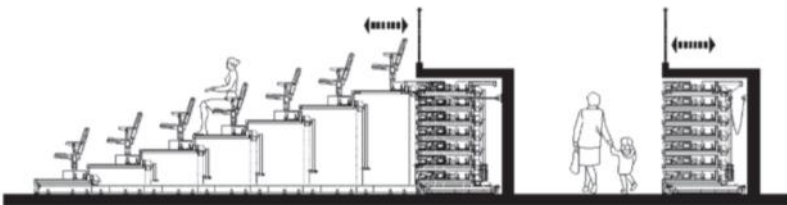

WALL RECESSED

The wall recessed system can be stored under the cantilever. When the system is extended, it is guided until the end of the cantilever and subsequently extends one deck at a time from the first row.

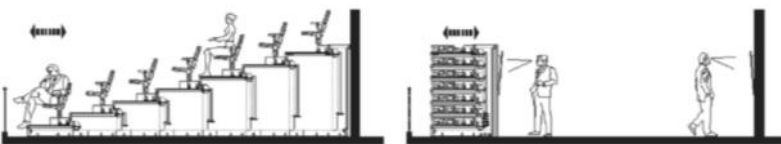

FORWARD RETRACTED

The first row is fixed onto the floor whereas the last row is extended to the back and retracted to the front direction.

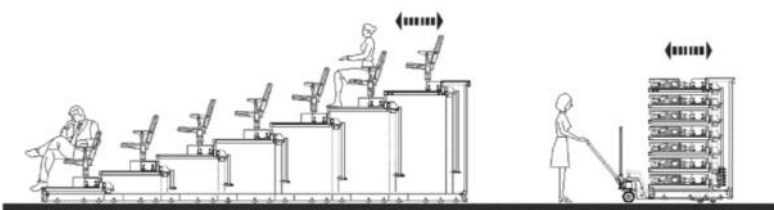

MOVABLE

The system can be moved to other places using a special portable trucking trolley. The system should be completely retracted prior to the system being moved to the desired location. Once the system is moved to the designated area, the system can be extended or retracted manually or automatically.

OPERATION OF DECKS

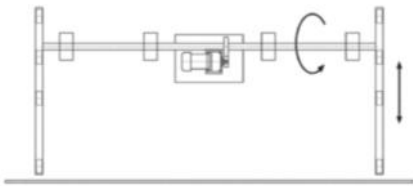

Remote Control

These can be operated via wired or wireless remote control.

AUTOMATIC PULLING OPERATION

Four wheel or six wheels per unit on a shaft with a geared motor to smoothly extend or retract the system. The wide earthing points allows a safe mode of operation and provides additional protection to the flooring.

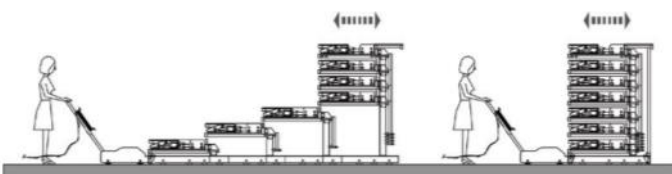

PORTABLE ELECTRIC PULLING UNIT

A motor is equipped on a special operated cart. When extending or retracting the system, the operating cart must be connected to the first deck each time where the system is operated electrically.

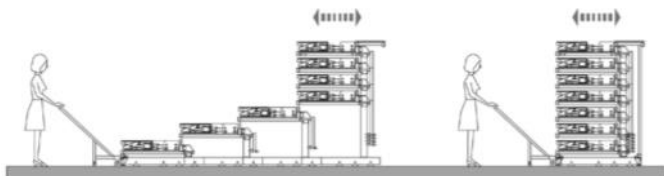

MANUAL PULLING UNIT

There are no electrical parts on the manual pulling units. When extending or retracting the system, the manual pulling trolley must be linked to the first deck of the system where it is pulled automatically.

OPERATION OF SEATS

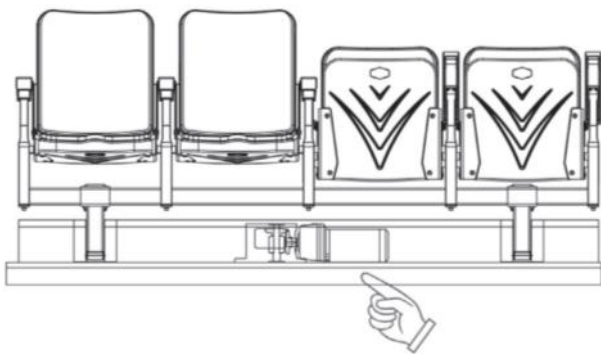

AUTOMATIC UP-DOWN MECHANISM

The seats are raised up or down by motorized operation as the system opens and closes. The motor and gear box are located under the seats and are completely covered by a folded steel plate to ensure safety of the audience.

MANUAL UP-DOWN MECHANISM

The seats are raised up or down manually using a crank bar. The bar locks or opens the device which is located below the operating box. Each crank bar is usually connected to three or four seats, but can be connected to more seats for a faster set up.

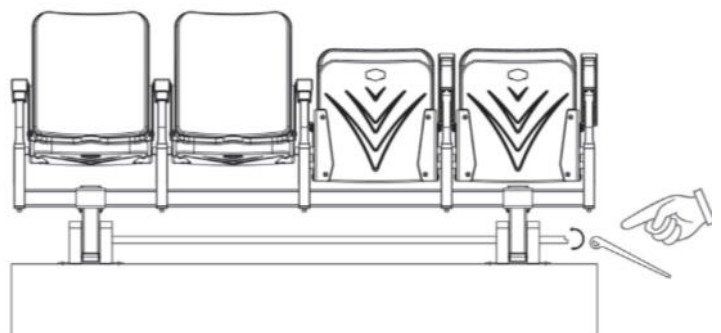

TB SERIES



TBF

These are fully upholstered seats. The seat and backrest are cushioned with a thick foam padding covered in fabric upholstery that meets BS5852 Source 0,1 and 5.



TBF-WW

The seat and backrest are cushioned and upholstered with fabric. The outer shell of the seat and backrest is made from plywood with a beech veneer.



TBF-PP

The seat and backrest are cushioned and upholstered with fabric. The outer shell of the seat and backrest is made from HDPE plastic.

TB SERIES



TBP

These seats are made from blow-moulded HDPE (High Density Polyethylene) and marry the concepts of hardness and ease of maintenance with ergonomic comfort.

TB SERIES ACCESSORIES



Writing Tablet (Laminated Wood)



Armrest (ABS Plastic or Wood)



Cup-holder

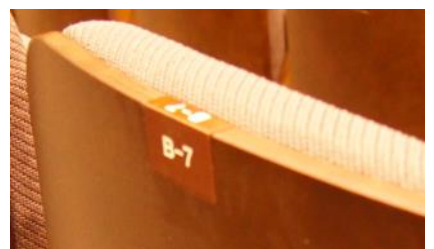

Seat Numbering (bronze plate)



TB SERIES

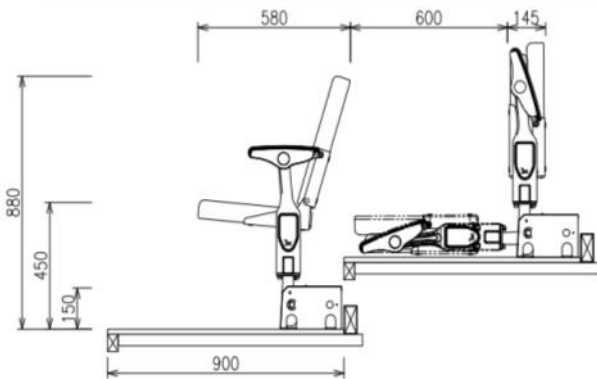
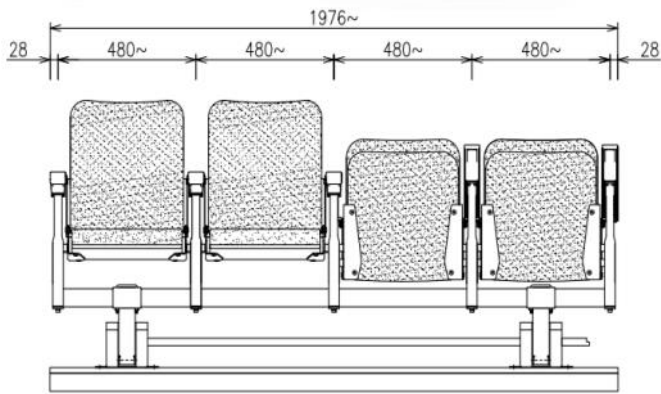

DESCRIPTION

- Seat and Backrest Upholstered Cushion / HDPE Plastic
- Seat Shell & Backrest Shell Upholstered / Plastic / Wood
- Centre to Centre Model Dependent
- Tip Up Mechanism Counterweighted
- Support Powder Coated Die Cast Aluminum
- Bracket Powder Coated Folded Steel Plate
- Horizontal Bar Powder Coated Rectangular Steel Pipe

TIP UP SEATS

TB SERIES



ARCLITE COMPACT

The ARC is a group of fixed stadium seats designed to encompass everything from the bucket type to the plush VIP style. Already successfully installed at prestigious venues like Hoffenheim's Rhein Arena, Dubai Sports Complex and Stuttgart Mercedes Benz Arena, the telescopic ARC lite and ARC lite compact was developed to provide retractable seating solutions for venues that require flexibility.

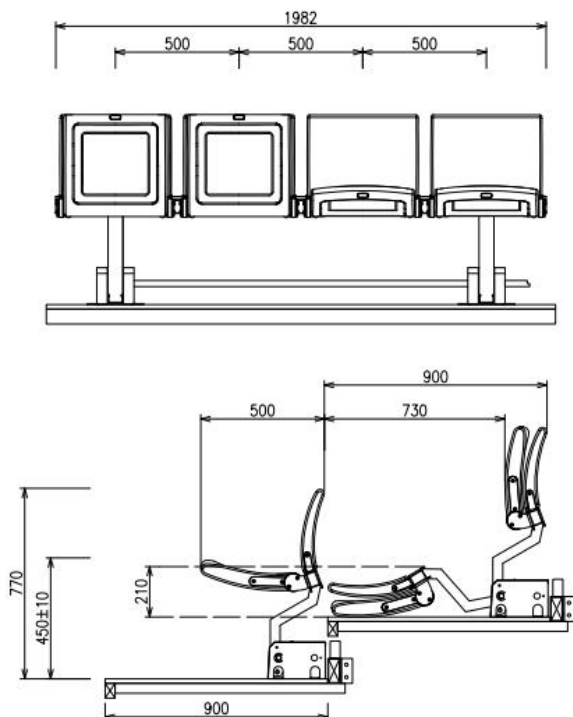

DESCRIPTION

Tip Up Mechanism Counterweighted

Seat and Backrest Blow Moulded Polypropylene or Polyethylene

Bracket Powder Coated or Galvanized

Centre to Centre 500mm

ARCLITE COMPACT

Hoffenheim Rhein Neckar Arena



Dubai Sports Complex



TIP UP SEATS



FCB-M

Like the ARC family, the telescopic FCB-M is the retractable solution for the FCB family.

Originally designed by Herzog & de Meuron for Munich's Allianz Arena, this compact seat has already been installed at various parts of the VIP section of Manchester United FC Ahoy Arena at Rotterdam, to the Salzburg Red Bull Arena in Austria.

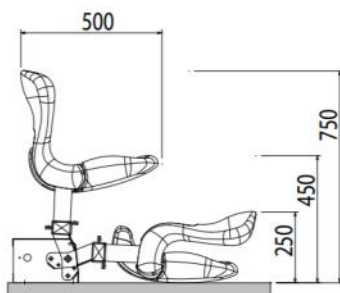
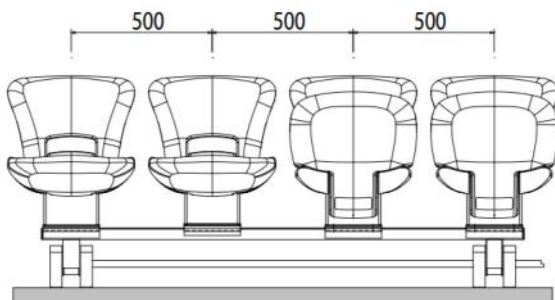

DESCRIPTION

Tip Up Mechanism Counterweighted
Seat and Backrest Polypropylene Blow Moulded
Bracket Powder Coated or Galvanized
Centre to Centre 500mm



FCB-M

Debrecen Swimming Centre, Hungary



Reyno de Navarra, Spain



Munich Allianz Arena, Germany



FD SERIES



FDP

These seats are made from blow-moulded HDPE (High Density Polyethylene) and marry the concepts of hardiness and ease of maintenance with ergonomic comfort.



FDF-WW

The seat and backrest are cushioned and upholstered with fabric. The outer shell of the seat and backrest is made from plywood with a beech veneer.



FDF-PP

The seat and backrest are cushioned and upholstered with fabric. The outer shell of the seat and backrest is made from HDPE plastic.

FD SERIES

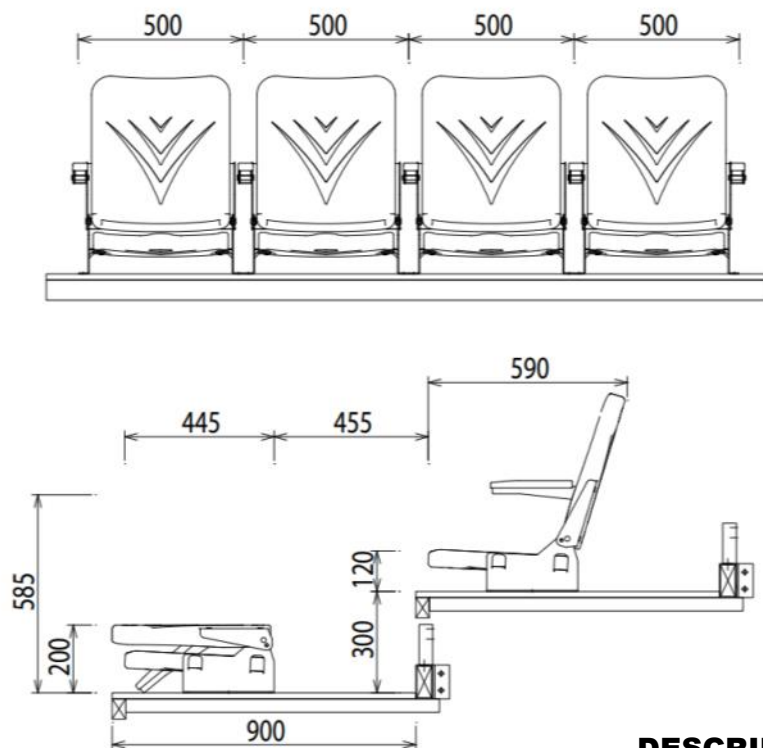

DESCRIPTION

Seat HDPE or Upholstered Fabric

Seat and Backrest Model Dependent

Bracket Powder Coated Folded Steel Plate

Centre to Centre Model Dependent

FOLD DOWN SEATS

FD SERIES

FD SERIES ACCESSORIES



Cup-holder



Armrest (ABS Plastic or Wood)



Seat Numbering (bronze plate)



FD SERIES



BENCH SEATS

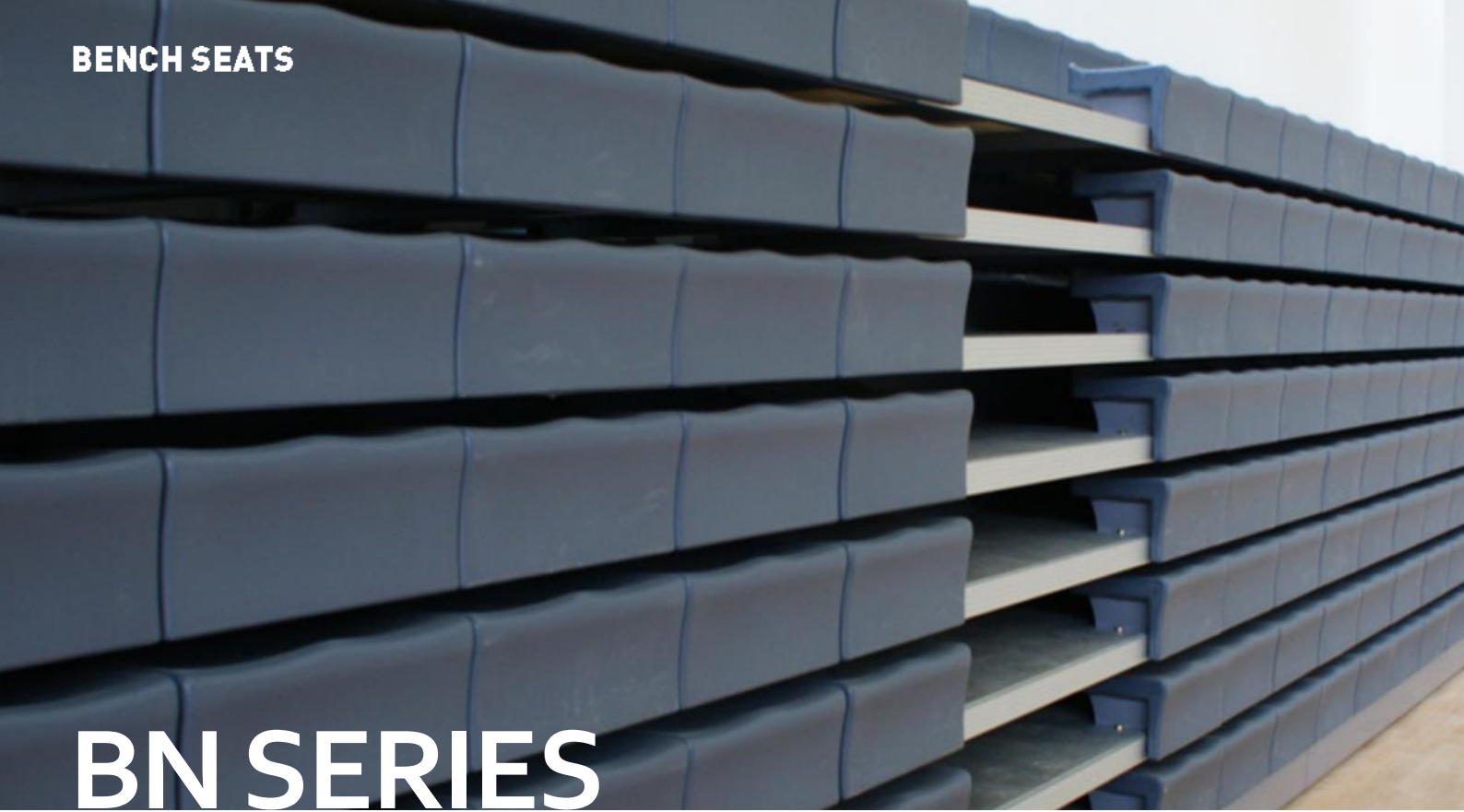

BN SERIES

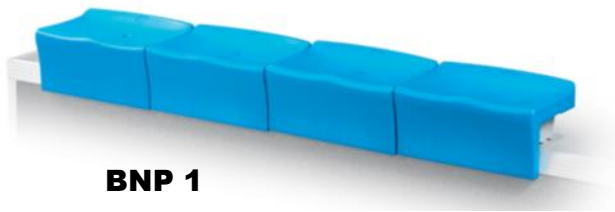

BNP 1

DESCRIPTION

Seat High Density Polyethylene Blow Moulded (HDPE)
 Bracket Powder Coated Folded Steel Plate (1.6mm thick)
 Centre to Centre 455mm to 550mm

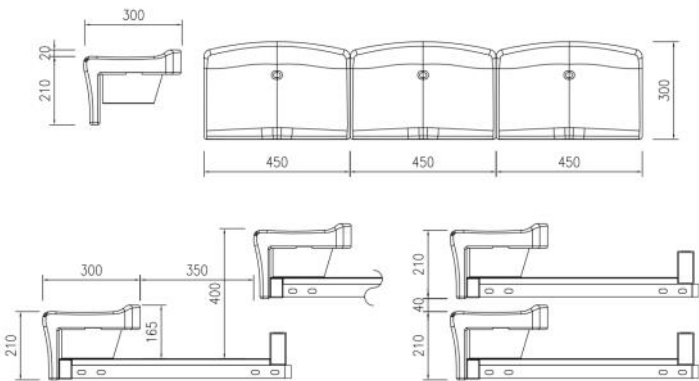

BNP 2

DESCRIPTION

Seat High Impact Resistant Polypropylene Injection
 Bracket Powder Coated Folded Steel Plate (1.6mm thick)
 Centre to Centre 450mm to 550mm

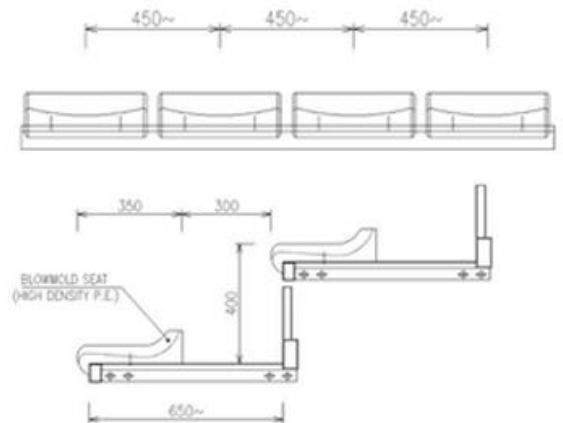



BN SERIES



BNW

DESCRIPTION

Seat Wooden Bench (HPM on 18mm plywood)

Bracket Powder Coated Folded Steel Plate (1.6mm thick)

Centre to Centre 450mm to 550mm

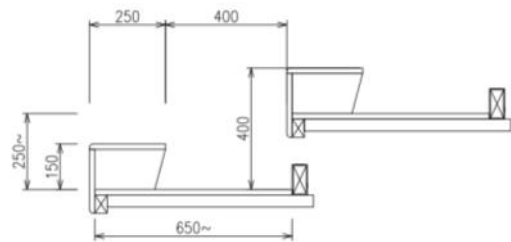

BNF

DESCRIPTION

Seat Wooden Bench (HPM on 18mm plywood) covered in upholstered padded fabric.

Bracket Powder Coated Folded Steel Plate (1.6mm thick)

Centre to Centre 455mm to 550mm

BENCH SEATS



BN SERIES

BN SERIES ACCESSORIES



Upholstered Backrest



Wooden backrest

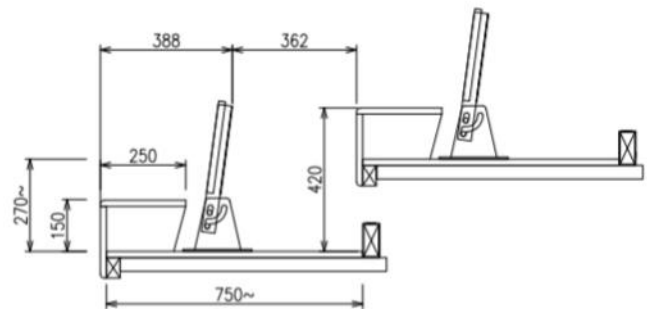
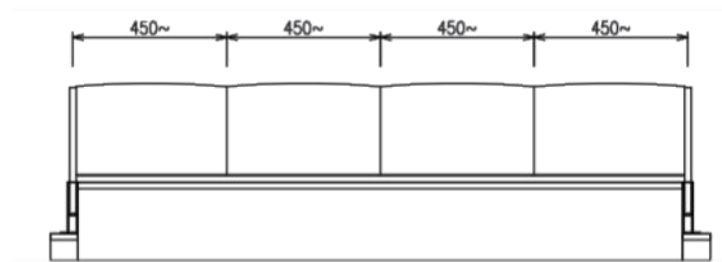

BN SERIES



SYSTEM OPTIONS

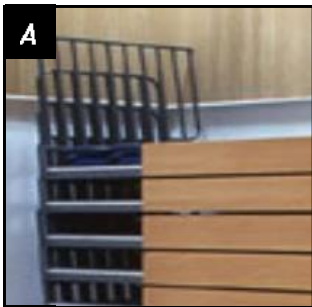

A



B



C

(A) **Self storing guide rails** retract with the system.

(B) **Removable guide rails** need to be manually removed before operation.

(C) **Folding guides** fold down onto the deck and can be retracted safely with the platform for storage.



D



E

(D) **Fascia panels** provide a pleasing aesthetic when the system is in storage and protect the system when in storage.

(E) Motorized systems are provided with a covered plug at the front of the unit to attached to the wired **remote control**.

Operating the system is as easy as pushing the buttons on the remote to extend and retract the system. Optional buttons to raise and lower the seats are provided if automatic seat operation is chosen.



F

(F) **Stackable FORTUNE chairs** with porting trolley. These chairs are light, very resistant to damage and designed for flexible comfort. These chairs can be ported to location and stored away quickly with its trolley. With a unique linking mechanism, these chairs can be used individually or linked together to create a row of seats.

SAFETY OPTIONS

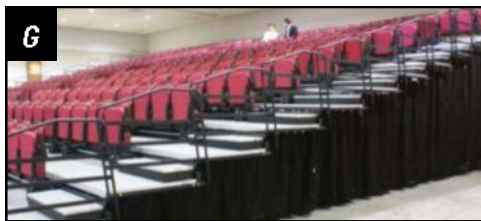

(G) Removable **side drapes** to hide the understructure and prevent unauthorized entry.

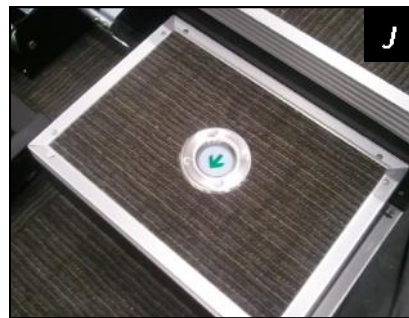

(J) **Aisle lights** with non-slip aluminum nosing are recommended for spectator safety.



(H) An warning **audio** alarm and **strobe light** are added safety features, that activates when the system is being operated.



(K) **Obstacle sensors** mounted on the leading platform automatically stop operation when an obstruction is detected and resumes when clear. Additional safety measures include sirens and warning lights.

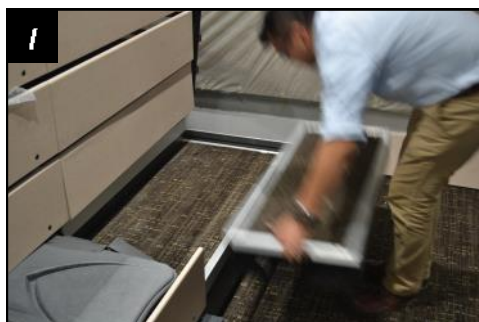

(I) All retractable systems are provided with a demountable half step for the first row of the unit.

ferco

SHUTTERS & SEATING

LONDON

Unit 28
Atcham Business Park
Shrewsbury SY4 4UG

Tel : +44 (0) 8458 123 100
Fax : +44 (0) 8458 123 101
info@fercoseating.co.uk

SINGAPORE

120 Hillview Avenue
#04-04 Kewalram Hillview,
Singapore 669594

Tel: (65) 67608383
Fax: (65) 67607503
sales@fercoshutters.com

MALAYSIA

No. 7 Jalan Sungai Besar 26/7
Section 26 40400 Shah Alam
Selangor Darul Ehsan, Malaysia

Tel : +60 (0) 3 51913233
Fax : +60 (0) 3 5192 9313
marketing@fercoseating.co.uk

DUBAI

Plot 247-125 Shed 1 & 2
Al Qusais, Industrial Area 4
P.O. Box 233962 Dubai UAE

Tel: +971 (04) 2586433
Fax: +971 (04) 2586533
enquiryUAE@fercoshutters.com