

IFSS / Insulated Fire *Stacking* Shutter

2 HOURS FIRE RATING + 2 HOURS INSULATION

- Single layer steel panels with no fabric components
- Super compact guide rail with no air gap needed
- Can be operated daily as a security shutter
- Civil Defense Approved
- Tested to EN 1634-1:2014 and SS489:2015

**10 YEAR WARRANTY
ON STEEL PANELS!**

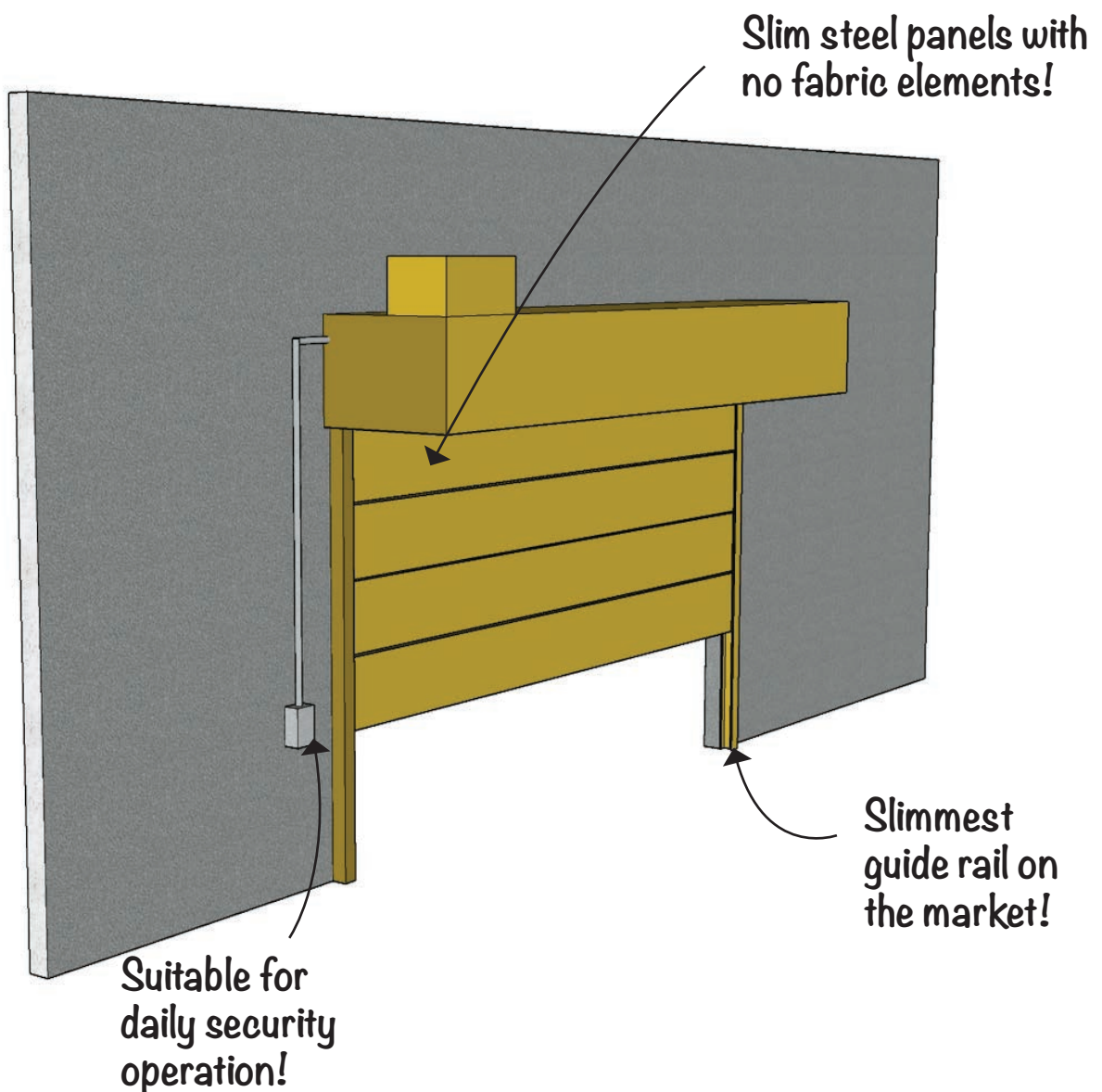

WHY DO FIRE SHUTTERS NEED TO BE INSULATED?

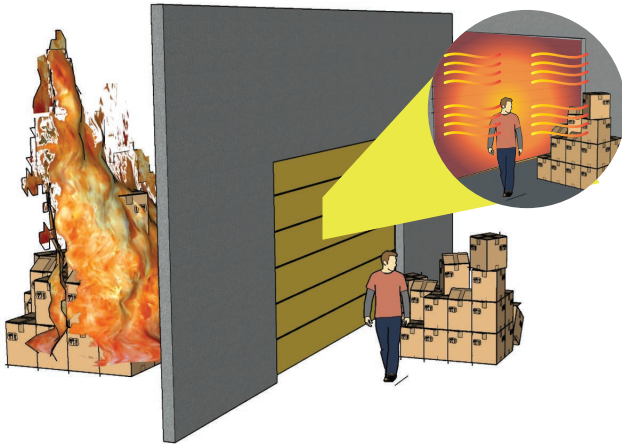

The temperature of a fire raging through a building can easily exceed 1100 degrees C. Traditional un-insulated steel roller shutters may deploy and create “fire compartmentalization” but at these high temperatures, they glow red hot and throw off intense radiated heat on the other side. This can combustible materials to ignite on the other side and also severely injure people attempting to escape. This creates the need for a fire shutter that is insulated in such a way that the temperature of the shutter on the non-fire side does exceed dangerous levels. This would ensure that people could safely pass in the front of the shutter while escaping, and also ensures that combustible materials do not ignite.

WHY SHOULD YOU CHOOSE FERCO’S IFSS?

STEEL PANELS = DAILY SECURITY

The IFSS is made from interlocking steel panels which means it can be operated daily as a security shutter. Other products use fabric elements which tear after a few operations, look unaesthetic and pose security concerns.

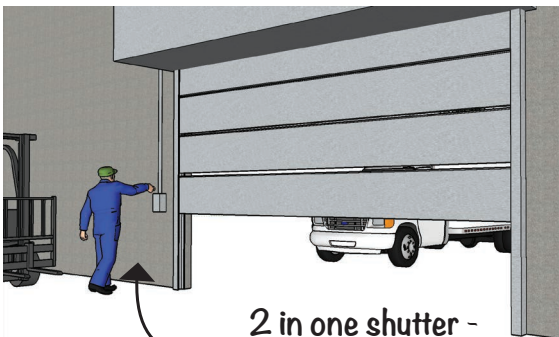

2 in one shutter - robust steel panels you can operate it daily for security needs!

Easy Maintenance

Steel panels are easy to clean and last for decades.

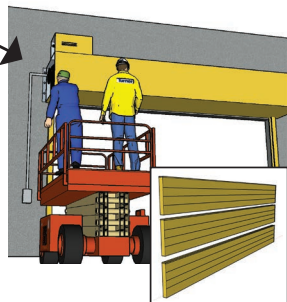

Damaged steel panels can easily be replaced. Remember that fabric products will eventually tear and look terrible!

REMARKABLY SLIM GUIDE RAIL

Other insulated fire shutter guide rails take up a lot of room because they have two thick fabric blankets separated by an air gap, and it all needs to be boxed up. They may also require additional fire board protection, fire protection of hollow sections and so on. The IFSS has a compact insulated guide rail of just 150mm x 180mm which means more footprint and clearance for daily operations.

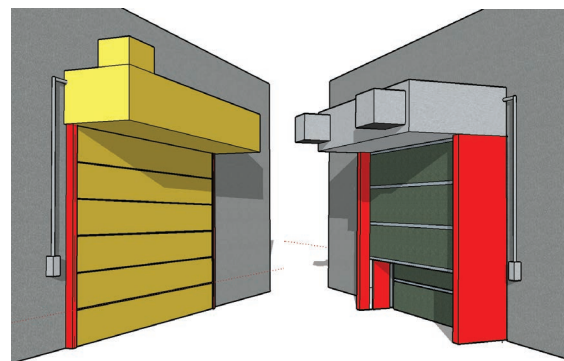

3x to 4x slimmer than other products that need air gaps!

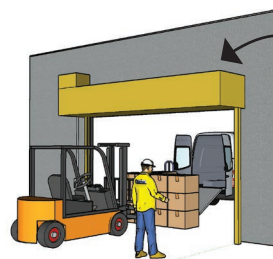

Guide rail so slim it doesn't obstruct daily operations!

CONSTRUCTION

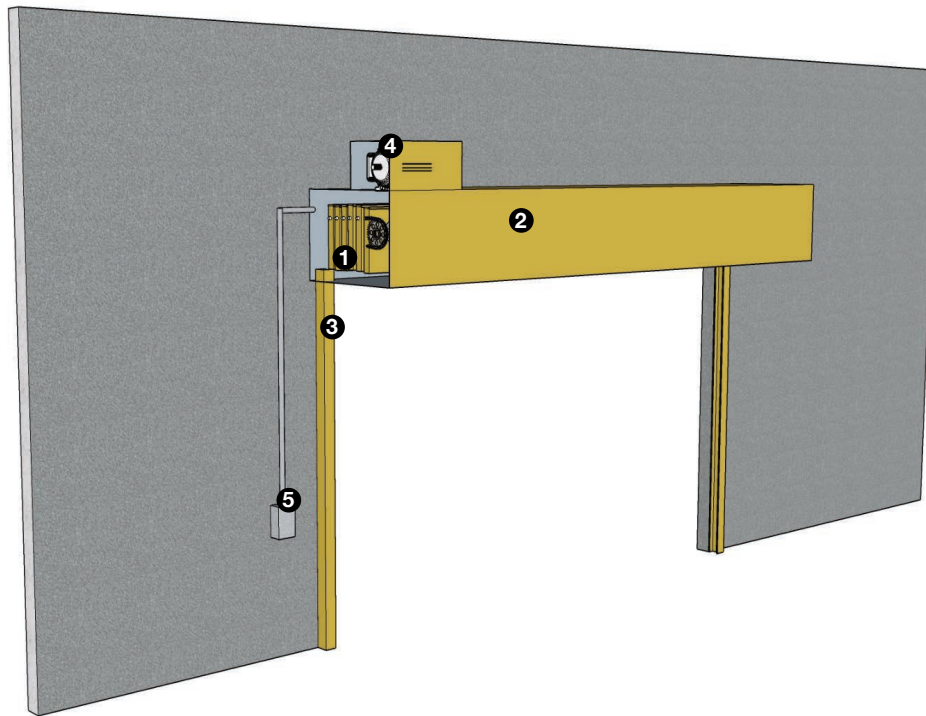

1. ROBUST STEEL PANELS

Both faces are finished in folded galvanized steel enclosing a sandwich of fire rated and insulating materials that are both non-combustible and non-toxic. The panels are solid, in a single layer and require no air-gap in order to achieve the desire insulation rating.

2. SHUTTER BOX

The shutter box is installed behind a lintel and houses the panels when the shutter is open. The box is made from steel sections fitted between heavy duty endplates. The shutter box is covered in a folded galvanized steel sheet.

3. SIDE GUIDES

The raising and lowering of the panels of the door are guided via steel side guides on either side of the door opening.

4. MOTOR OPERATOR

The motor is suitably sized with a fully enclosed design. The motor has a high starting torque, built-in gear box and a built-in thermal protector. The motor gearbox has a inbuilt centrifugal type speed governor that reduces the speed of the shutter during gravity descent. In case of power failure, an endless hand chain is provided for manual operation from the ground level. Adjustable limit switches are used to set the upper and lower limit for the travel of the curtain.

5. PUSH BUTTON

Push button control with 'up', 'down' and 'stop' buttons are housed in a lockable push button box.

Activation in a fire

Fire Alarm Signal: Where fire shutters are needed to be activated by fire alarm signal, a dual fusible link (electric solenoid releaser) is used which releases the brake of the motor, upon receipt of a 24V DC, 400mA signal.

M&E requirements

1 phase, 230V, 50Hz, 13A / 3 phase, 415V, 50Hz, 20A power supply at shutter box location.

DRAWINGS AND CRITICAL DIMENSIONS

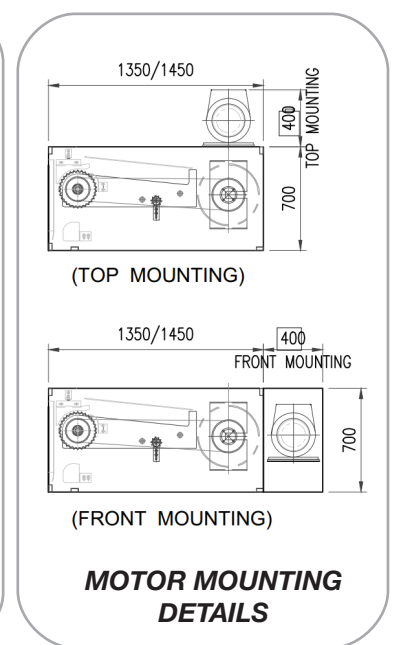
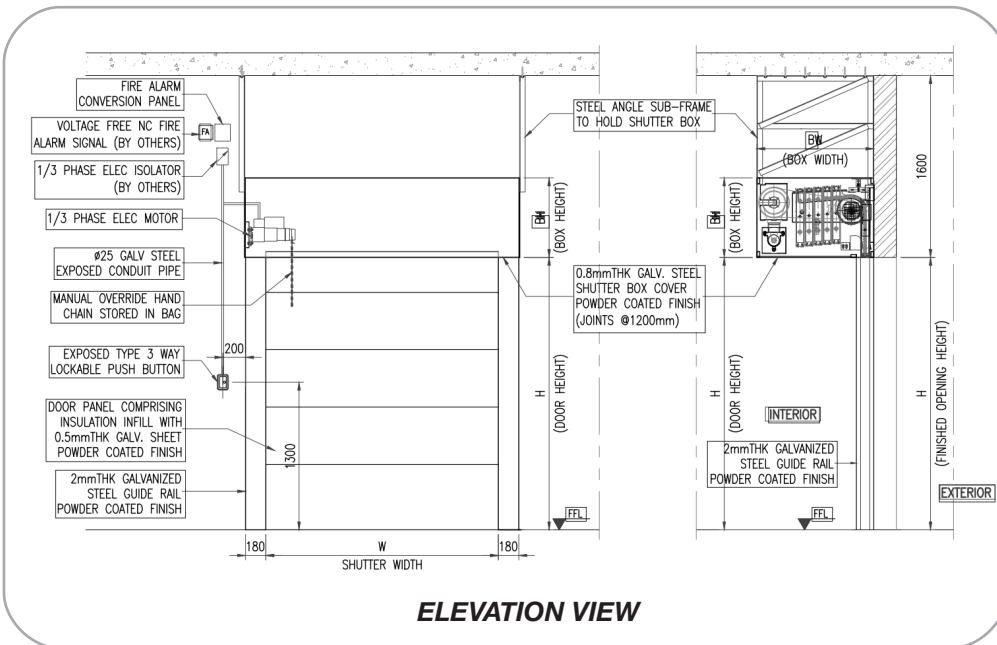
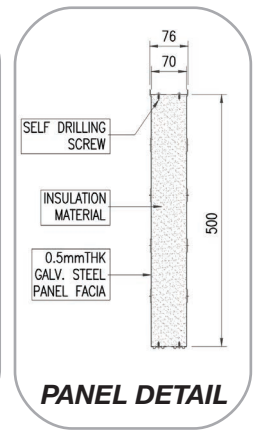
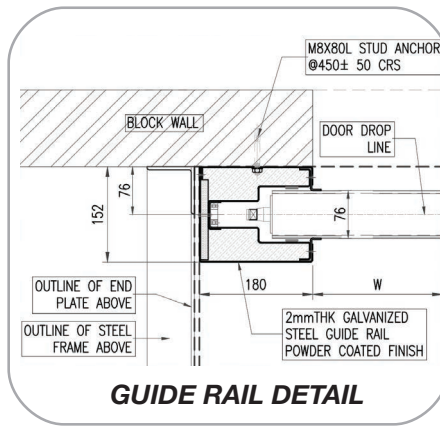
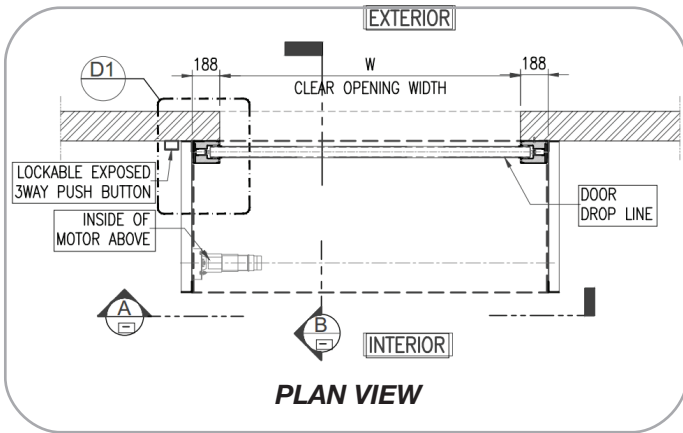

Clear Opening Width (W)	Clear Opening Height (H)	End Plate Width (BW)	End Plate Height (BH)	Motor Fixing Options
1000 - 8000	1000 - 2500	1030	700	Inside
	2500 - 4000	1350		Top/Front
	4000 - 5000	1450		Top/Front

INDIA

S.No. 8/1A2B, 8/2A2,
Industrial Shed, Parivakkam Road,
Senneerkuppam, Poonamalle,
Chennai - 600 056
Tamil Nadu, India
salesindia@fercoshutters.com

DUBAI

Plot 247-125 Shed 1 & 2
Al Qusais, Industrial Area 4
P.O. Box 233962 Dubai UAE
Tel: +971 (04) 258 6433
Fax: +971 (04) 258 6533

SINGAPORE

120 Hillview Avenue,
#02-04 Kewalram Hillview,
Singapore 669594
Tel: +65 6760 8383
Fax: +65 6760 7503