



V-LAB ELECTRONICS
Trusted by Engineers

AutoVin & Auto Scan

Automatically retrieve the vehicle identification number for comprehensive all available systems scan for quick diagnostics.



PS70 PRO Diagnosis System

PS70 PRO is a high-end and new style auto diagnostic device developed by XTOOL based on Android system. Its open source Android operating system provides fast boot-up and multitasking. PS70 PRO provides extensive vehicle coverage for most US, Asian and European makes, which makes it the best solution for workshops.

PARAMETER

| | | | |
|------------------|----------------------|---------------------|--------------------------------------|
| Operating System | Android | RAM | 1GB |
| Display | 7.0 Inches | CPU | Quad-Core Processor 1.6GHz Processor |
| Battery Capacity | 4000mAh | Audio Input/ Output | Microphone / Speaker |
| Communication | Wifi/main test cable | Dimension | (L*W*H):218*150*29(mm) |
| ROM | 32GB | Resolution | 1024x600 |



V-LAB ELECTRONICS
Trusted by Engineers

Vehicle Coverage

Asian: Tata (India), Mahindra (India), Maruti (India), Hyundai, KIA, Toyota, Honda, Nissan, ISUZU, Mitsubishi and many more

American: Ford, Chevrolet, GM, Jeep, Fiat and many more

European: Audi, Benz, BMW, VW, Skoda, Bentley, Volvo, Jaguar, Land rover, Renault and many more

Free Software update: 3 years from date of software activation

Features:

It will Read all Vehicles modules like ECM/PCM, ABS, SRS, BCM, TCM, IMMO. etc

Module Information

Read Fault Code

Clear Fault Code

Read Data Stream

Read Freeze frame

Actuation Test

Special Function

- Injector coding
 - ✓ Read Injector code
 - ✓ Write injector code
- ECM/ PCM Flashing
- Key programming(Immobilizer)
 - ✓ Unlock ecm/immo.
 - ✓ Key programming
 - ✓ Remote programming

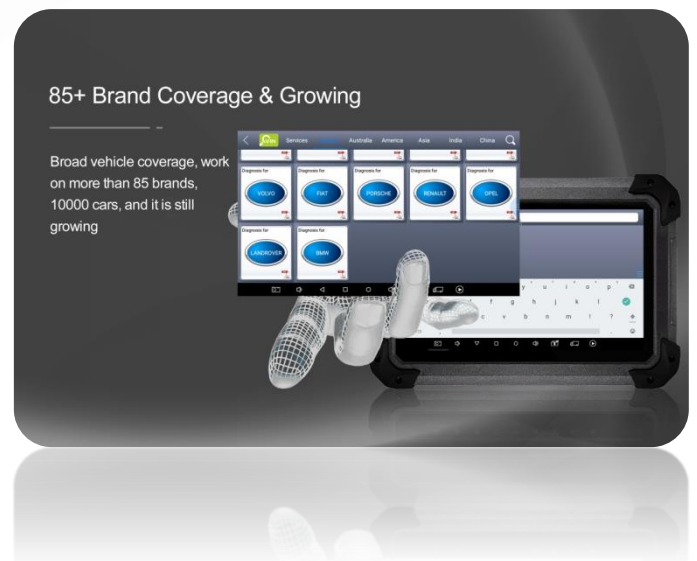

NOTE:

- **This tool is especially dedicated for Mahindra (India) Vehicles.**
- **All option will vary; it depends on vehicle variant and model year.**



V-LAB ELECTRONICS
Trusted by Engineers

Main Frame Image



Full Box Image

