

# ATF-305

## WiFi In-Built

## Cloud In-Built

### 500 Face/Card/Password

### 5000 Fingerprint



## Face Recognition Time & Attendance Terminal

ATF-305 face recognition time & attendance terminal support up to 500 face templates, 5000 fingerprint 500 card/password with TimeWatch latest hardware platform and algorithm, it offers brand new and user-friendly operation interface to provide smooth user experience. With advanced face algorithm and mult-biometric verification technology, the terminal's security level of verification is significantly enhanced.

### Features

- 500 face and 5000 fingerprint /
- 500 card /password templates
- High verification speed
- Advanced and user-friendly UI
- Built-in battery backup
- Providing approximately 2 to 4 hours of continuous operation (depend on usage)
- New framework firmware, easy to extend functions and customize client's requirements
- One face template is registered for one user only
- Built in access control
- Time Zone
- Door (Open/Close)
- User - Validity
- **Cloud In-Built**
- **WiFi In-Built**

# SPECIFICATIONS

- User Capacity : **500 Face, 5000 fingerprint & 500 Card/password**
- Log Capacity : 160000
- Communication Interface : TCP/IP, (LAN / WAN)
- FRR : 0.001%
- FAR : 0.00001%
- LCD : 2.8" TFT Color Screen
- Verification Time : <0.5 Sec
- Identification Mode : FP, ID+FP, PW, FP+PW
- Fingerprint Image Display : Yes
- Operating Voltage: 5V/2A
- Battery Backup: Yes
- Access Control : Yes
- Sensor : 600DPI
- **WiFi In-Built**
- **Cloud In-Built**

## Applications



Education



Retail



Government



Health



Logistics



Bank



Office



Factory

## Configuration

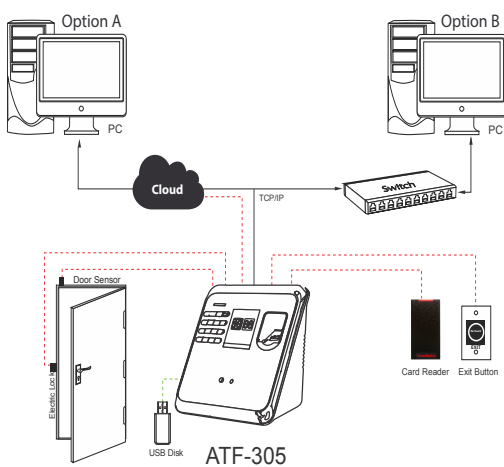

## What's in the Box



ATF-305

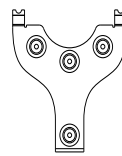

Back Plate

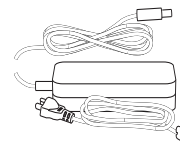

Power Adapter



Lines for Access Control Interface



Screws and Holders

[www.timewatchindia.com](http://www.timewatchindia.com)

DISCLAIMER : Brief specification are mentioned here. Specification may change without prior notice. Customer are advised to check with us before purchase Actual product may differ slightly to that depicted for ongoing product development