



# TRUCK AND INDUSTRIAL CRANES



**MATCHING  
YOUR TALENT**



# MATCHING YOUR TALENT

Kesla is the leading expert in modern truck-mounted and industrial cranes. Based on decades of experience in the field, we know how challenging the working conditions can be. That's why we always put the user first, offering the best ergonomics and usability for the most demanding needs. Whatever your talent and platform, Kesla is the perfect match with our durable, user-friendly products that adapt to your exact requirements.

**#yourlifetimematch**



**Welcome  
to the proud  
Kesla squad!**



## Tools to meet the needs of top professionals

For us at Kesla, the driver is king. The best drivers are sought-after professionals who require the right tools to suit their specific needs. With this in mind, we have developed the productivity of our cranes and the working conditions provided by them to meet the needs of top professionals.

Since its inception in 1960, Kesla has based its operations on proprietary product development. Over the course of more than 60 years, we have manufactured tens of thousands of cranes and exported them to almost 50 countries. This would never have worked if we would not have understood the needs of our customers and listened to them every day.

We understand that the investment is considerable and requires consideration. As such, no question is too small to warrant not contacting our sales team.

## A STRAIGHT BOOM OR A SPACE-SAVING Z-BOOM

In addition to models with straight booms, the KESLA range includes cranes with Z-booms, which provide the benefit of a transport position to save space.

## EFFICIENT OPERATION

The hydraulics solutions of our cranes have been designed to be spacious. This makes motions smoother and reduces fuel consumption. The wide-angle joint balances the lifting power in different boom positions.

# FEATURES

## DURABILITY

We have the latest production expertise and equipment, which we leverage to ensure the dimensional accuracy and seamless compatibility of our components.

We use premium high-strength steel (Strenx™) for our cranes. Our crane surface treatment line represents state-of-the-art technology and guarantees a durable surface finish.

The pipes and hoses of the crane are positioned inside the boom to provide protection. This also applies to the joint mechanism between the lifting and outer booms.

## EASY MAINTENANCE

Maintainability has been emphasised in the design of the KESLA 21 series cranes. This is evident in many of the technical solutions and the positioning of the service points. The cranes can also be fitted with centralised or even automatic lubrication. These solutions, which also improve the operational reliability and durability of the cranes, have been appreciated by our customers.

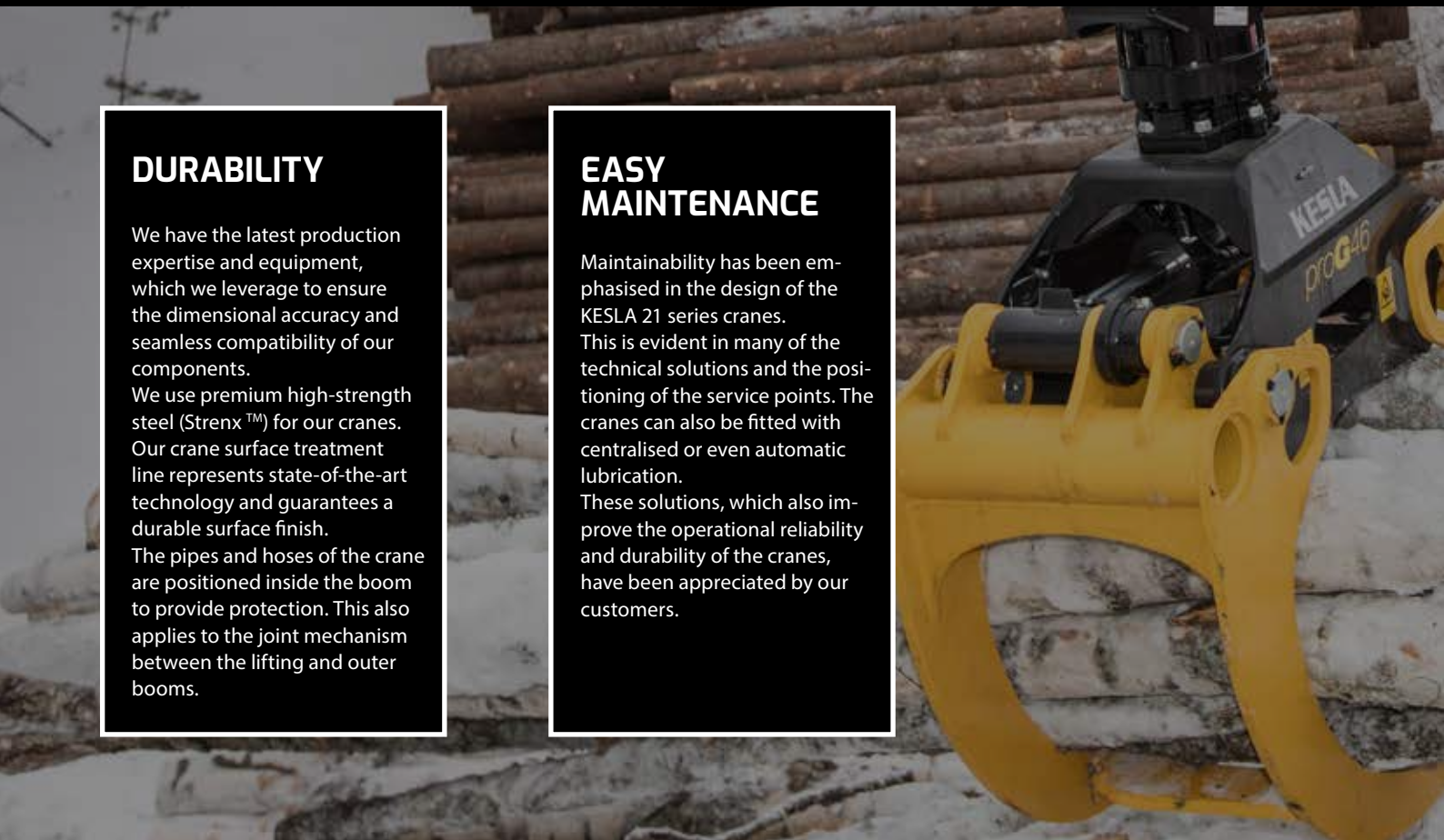
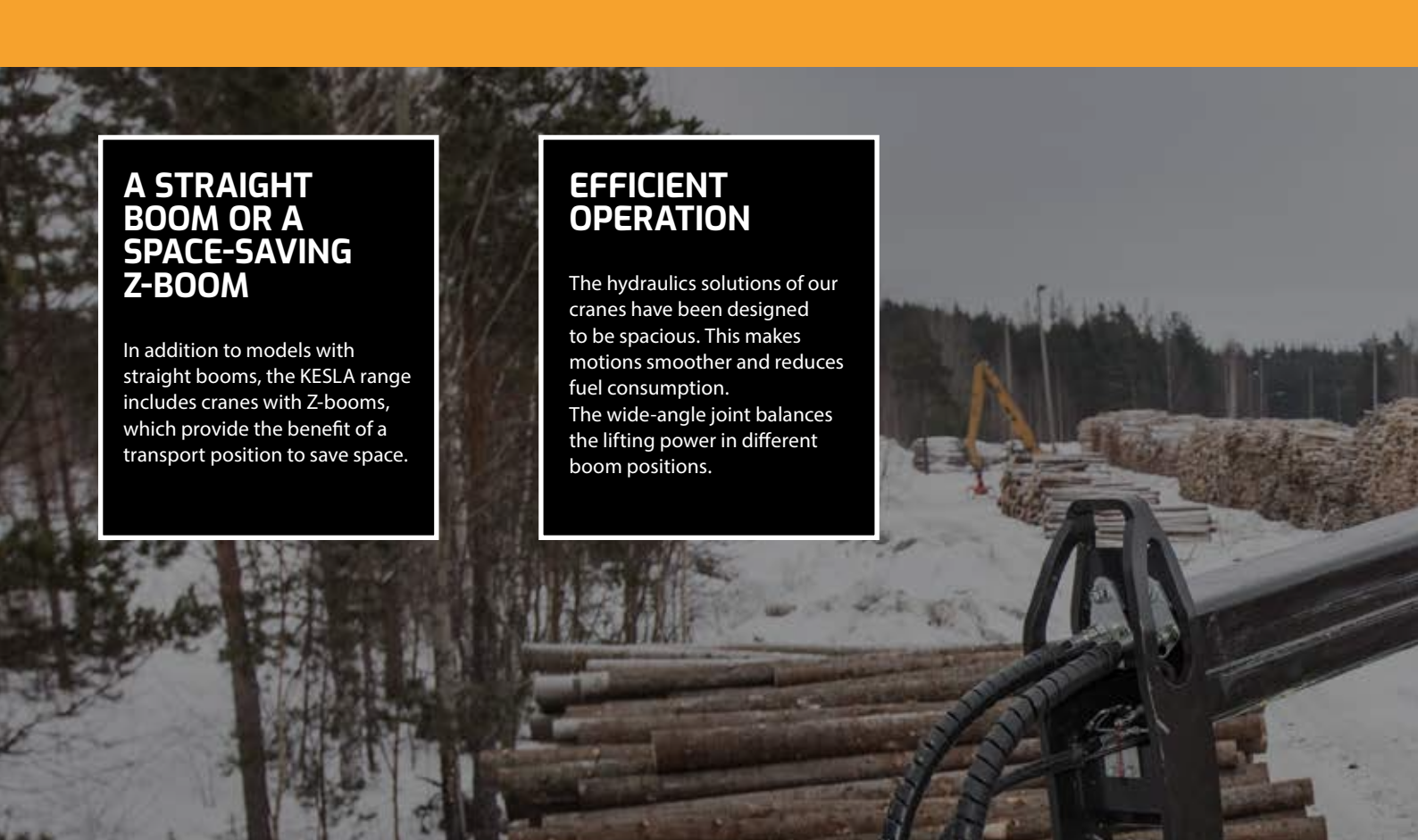



## EQUIPMENT CONTROL OPTIONS

KESLA truck cranes can be equipped with a high seat or cabin. Multiple options of both are available.

## END DAMPING FOR SMOOTH MOTIONS

The rotation, extension, cabin lifting and cabin lowering motions of KESLA cranes feature end damping.

## CONTROL SYSTEMS

KESLA cranes can be controlled by means of mechanical or electric control solutions. The most popular electric control system is KESLA proC.

## STABILISER LEGS

For most cranes, buyers can select a separate stabiliser leg beam instead of the integrated stabiliser leg beams, which increases the flexibility of bodywork. Crane stabiliser legs are available with a wide variety of cylinder lengths, and there are many alternative transport positions for the legs.

## STANDARD OR TALL PILLAR

Most cranes with a straight boom can be fitted with a tall pillar in addition to the standard pillar, which enables the load space to be used efficiently.

## STRUCTURE OF OUTER BOOMS

The structure of outer booms is simple and reliable. Hoses are protected inside the booms and change of those takes less than 10 minutes.



# STRAIGHT-BOOM CRANES

KESLA straight-boom cranes are known for their traditional straight boom solution. Our range includes straight-boom cranes from the 9-tonne-metre category all the way to 24 tonne-metres. They are particularly suitable for cut-to-length (CTL) operation, and the strongest cranes can even handle long timber. Our cranes are also popular in chipper feeding and fixed industrial installations.

[Learn more about the range of straight-boom cranes](#)

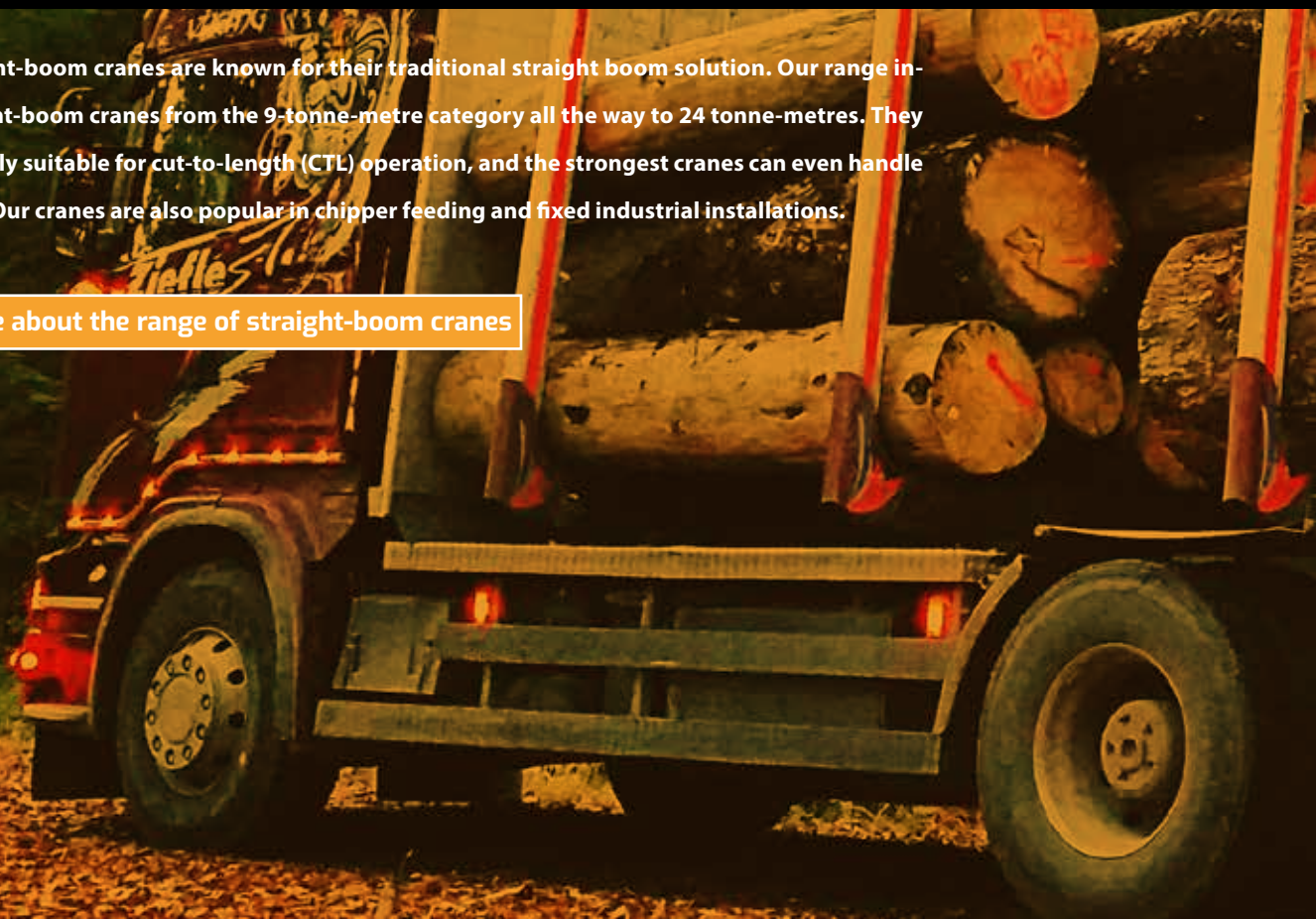









**"WE VALUE DURABILITY  
MOST OF ALL."**

Frischfaser Karton GmbH manufactures paperboard. The company utilises KESLA 2115 cranes. Alongside the durability, the company is happy with the cabin that provides comfortable working conditions.

**Reinhold Moser,  
Frischfaser Karton GmbH**





**"IT'S LIKE WORKING FROM YOUR SOFA."**

Transport Lucet Frouin transports timber to local sawmills. The company's latest crane is KESLA 2028, which enables the handling of long and heavy timber. The handling of the crane and the working conditions of the cabin have received plenty of praise.

**Jean-Philippe Frouin,  
Transports Lucet Frouin SARL**





**“A TRADITIONAL 4-LEVER SETUP BUT ELECTRIC”**

Gröhn Transport's cranes are 12-tonne-metre KESLA cranes with straight booms. The latest cranes feature the electric KESLA proC control systems as a 4-lever solution, which has helped drivers familiar with traditional controls to transition to electric controls.

**Kari Gröhn, Gröhn Transport Oy**





### **“RELIABILITY IS NUMBER ONE”**

The current crane used by Pejun Kuljetus features a 4-lever KESLA proC control system, which ensures precise adjustments to each driver's liking. The utilisation rate of the crane is how, which is why reliability is important, as are comfortable working conditions.

**Jussi Pesonen,  
Pejun Kuljetus Oy**







# Z-BOOM CRANES

Z-boom cranes are excellent alternatives when the load space needs to be used optimally. It is no surprise, then, that Z-model cranes have gained in popularity year after year. Our range includes Z-boom cranes starting from the 9-tonne-metre category. The largest Z-cranes can temporarily reach a lifting power of 24 tonne-metres. Z-cranes are perfect as CTL cranes, and the largest models can also be used to process tree-length timber.

[Learn more about the range of Z-boom cranes](#)





### "25TH KESLA CRANE"

Kuljetusliike Eskola has primarily been using Z-model cranes due to the better utilisation of the load space and the smoother working process. The transport height is also lower, which makes it easier to drive under bridges. The latest crane is KESLA 2212Z, which features even better hydraulics.

**Pasi Eskola, Kuljetusliike Eskola Oy**





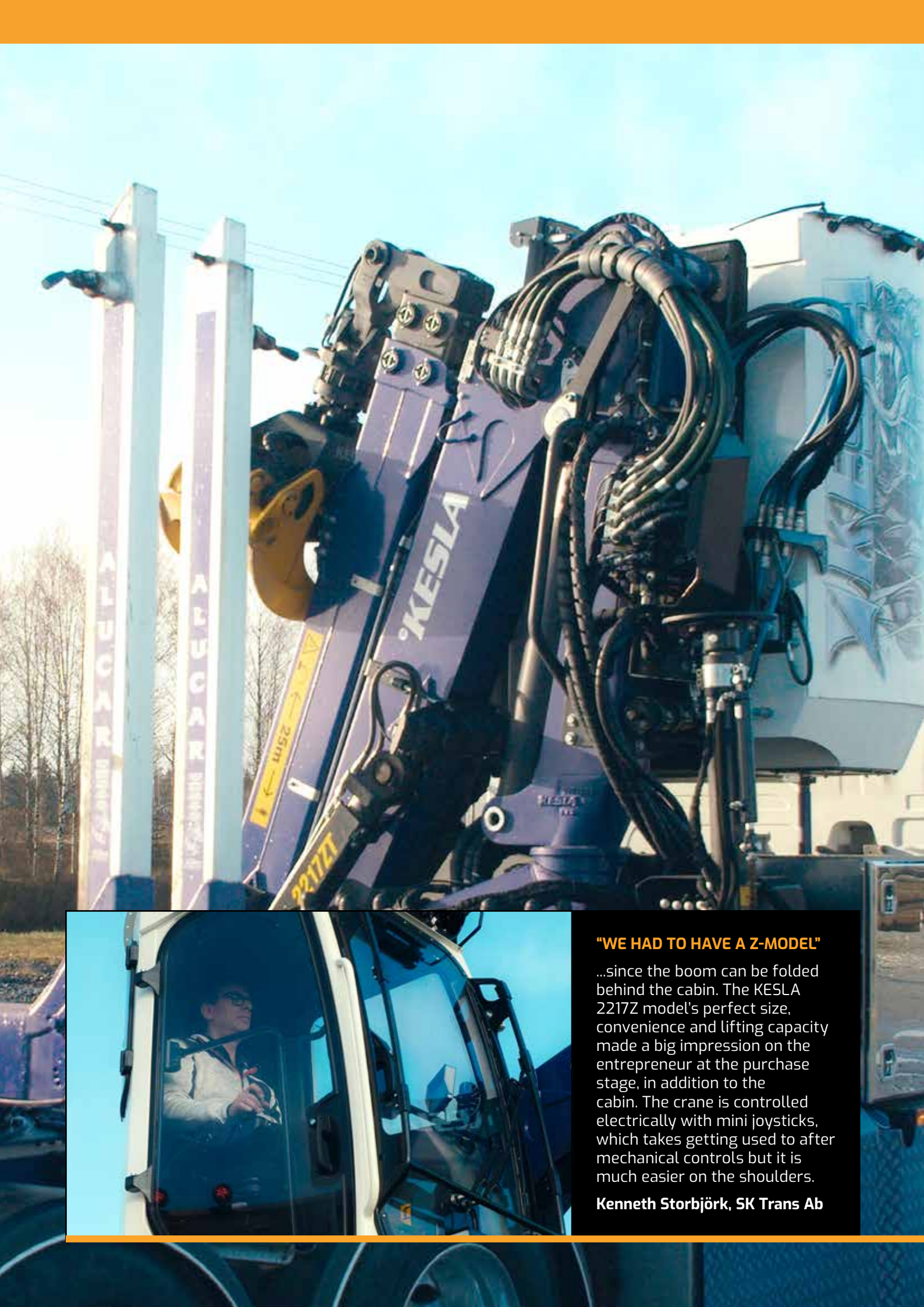

**“WE HAD TO HAVE A Z-MODEL”**

...since the boom can be folded behind the cabin. The KESLA 2217Z model's perfect size, convenience and lifting capacity made a big impression on the entrepreneur at the purchase stage, in addition to the cabin. The crane is controlled electrically with mini joysticks, which takes getting used to after mechanical controls but it is much easier on the shoulders.

**Kenneth Storbjörk, SK Trans Ab**



### **"QUALITY, STRENGTH, HANDLING"**

The company uses five KESLA cranes, one with a Z-boom and some with straight booms. Managing Director Cameron Smith appreciates the aftermarket support and the high quality, strength and handling of the cranes. The benefits of a Z-crane are clear: the load space utilisation and the lower transport

**Cameron Smith,  
Sheffield & Co Ltd**



**"WORKS EXTREMELY WELL!"**

The company uses 14 KESLA cranes. The cranes are front-fold Z-cranes. This maximises the truck's load space. KESLA cranes also boast superior lifting power and reach. Moreover, the hydraulic adjustments are great. And the drivers highly appreciate the cabin.

**Kari Malmstedt, KM Malmstedt Oy**





# WORK COMFORTABLY

## TRADITIONAL HIGH SEAT OR CABIN?

Crane operators are top professionals in their field. As such, they are able to demand conditions that best support their work.

A high seat is a good option for shorter work periods, and it can also be equipped with a weather shelter. Ergonomics can be further improved by equipping the high seat with the electronic KESLA proC control system with two weather-proof maximum levers and pedals, if necessary.

For longer work periods, a cabin is the best option. The cabin protects you against the weather and is usually equipped with a heater and air conditioning or a cooler. Cabins can also be fitted with a lot of accessories that add to the operator's comfort and working efficiency.

### TRADITIONAL HIGH SEAT



360° presentation

### KESLA VISION STANDARD CABIN



360° presentation

### KESLA VISION CABIN



360° presentation

### KESLA VISION XL CABIN



360° presentation

### HIGH SEAT PROC



360° presentation



# WE RECOMMEND ELECTRIC CONTROL

## WHY NOT TRY ELECTRIC CONTROL?

The benefits of electric control are undeniable. The control motions are small and light. This improves control ergonomics, especially for the shoulders, which are often strained by mechanical controls.

The motions can be adjusted individually, and the settings can be saved using the driver's name, for example.

All of this results in extreme precision, which leads to excellent productivity.

**Don't hesitate to try them out!**

## CONTROL METHODS IN THE CABIN

The KESLA Vision and Vision XL cabins provide amazing working conditions. Four different control methods are available for the cabin, all based on the KESLA proC control system.

**KESLA proC MINI 2**



**KESLA proC MAXI 2**



**KESLA proC MAXI 2 + 2**



**KESLA proC 4 + 2**

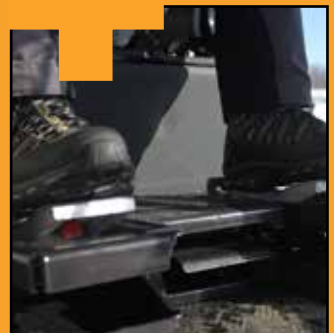

## CONTROL METHODS IN A HIGH SEAT

A high seat can also be paired with electric controls. Two different control methods are available for the open control device, based on the KESLA proC control system.

**KESLA proC MAXI 2**



**KESLA proC MAXI 2 + 2**







## **KESLA QUICK - mix and match!**

All professionals have their personal preferences. Now our cranes can cater to the preferences of many professionals at once, as regards the control methods. For electrically controlled cranes, you can purchase a KESLA Quick system which enables switching between control methods in 15 minutes. All four control methods are available for the cabin, and two are available for high seats.

[Watch the video](#)

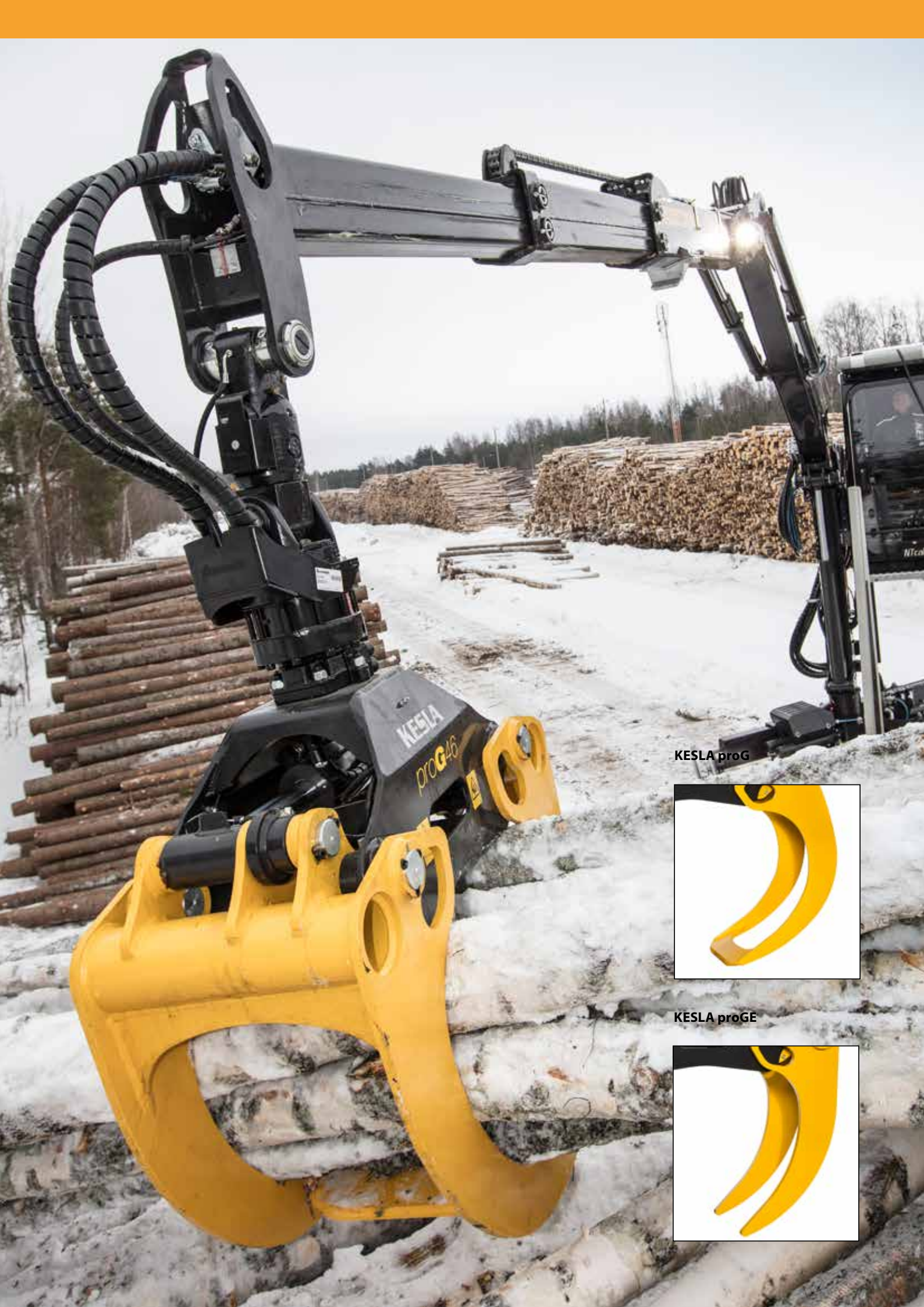

KESLA proG



KESLA proGE



# GRAPPLES

## KESLA PROG GRAPPLES

The KESLA proG series of grapples provides an optimal grapple for all KESLA cranes. The ProG series features 0.18–0.5 m<sup>2</sup> timber grapples and a variety of spike grapples for handling bioenergy wood and other materials. The geometry of the grapples makes timber handling easy and efficient, and the structural solutions ensures excellent durability and reliability.

## TECHNICAL SPECIFICATIONS

	Weight (kg)	Area (m <sup>2</sup> )	Operating pressure (MPa)	Gripping force (kN)	Maximum load (kg)
<b>28</b>	170	0.27	25	13	3 000
<b>30</b>	200	0.3	25	16	3 500
<b>30E</b>	245	0.21	25	18	3 500
<b>35</b>	215	0.35	26	16	4 000
<b>40</b>	265	0.4	26	21	5 000
<b>40E3</b>	300	0.25	26	21	4 000
<b>40E</b>	325	0.25	26	21	5 000
<b>46</b>	270	0.46	26	21	5 000
<b>50L</b>	225	0.5	26	17	3 500
<b>50</b>	280	0.5	26	21	5 000
<b>50E</b>	380	0.46	26	21	5 000
<b>50E6</b>	450	0.46	26	21	5 000

## DIMENSIONS

	A (mm)	B (mm)	C (mm)	D (mm)	E (mm)	F (mm)
<b>28</b>	1 610	100	480	434	835	590
<b>30</b>	1 565	100	480	442	890	580
<b>30E</b>	1 630	70	510	500	820	570
<b>35</b>	1 570	125	480	442	950	615
<b>40</b>	1 990	140	540	503	1005	675
<b>40E3</b>	1 955	70	575	471	965	610
<b>40E</b>	1 955	70	575	561	965	610
<b>46</b>	1 955	140	540	503	1 055	660
<b>50L</b>	1 960	130	540	495	1 150	680
<b>50</b>	1 960	130	540	503	1 150	680
<b>50E</b>	1 980	140	575	561	1 120	675
<b>50E6</b>	1 980	140	575	561	1 120	675

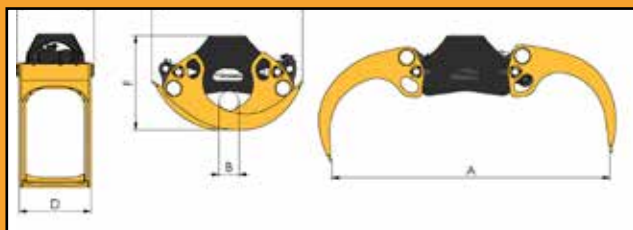

# ACCESSORIES

## Standard steps

The standard steps feature two footholds that can be freely placed on the stabiliser legs.

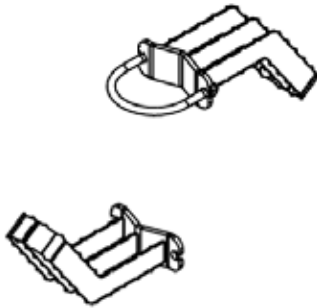

## Special steps

The special steps resemble a ladder and enable crane access in all positions of the stabiliser legs.



## Extra steps 1, 2

The optional extra steps make it easier to access the control position. The platforms can be installed on the right or left side of the crane, and they suit both straight-boom and Z-boom cranes.

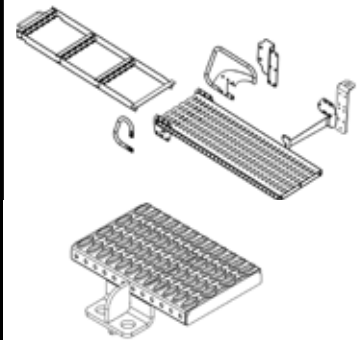

## Rotators

Strong rotator models are available for KESLA cranes: Balrotors GR 12S or Indexator GV12SA.



## Links and adapters

KESLA 20-series cranes feature an 80/35 link, and the 21- and 22-series cranes feature a KES-Link 60/45 link. An adapter kit is available for the latter.

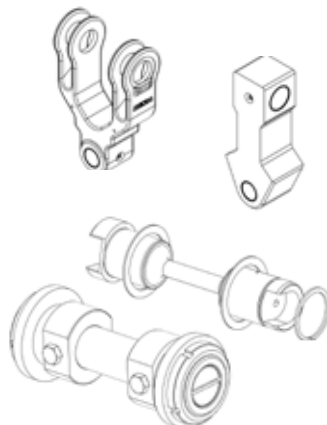

## Load control CE

KESLA CE is a control system for the load and transport position, which complies with EU directives.

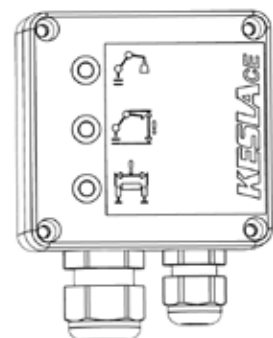

## Scale pipe kit

The factory-mounted scale pipe kit includes all of the pipes and cables required for a scale installation.



## Load monitoring Comfort

Includes load and stabiliser leg monitoring, tilt sensors, an emergency stop switch, switches for lights and the heated seat, rpm adjustment and two switches for customer-defined applications.



**"KESLA CRANES  
ARE DESIGNED  
IN COOPERATION."**

[Watch the video](#)

# ACCESSORIES



## Unloading valve

The unloading valve engages pressurised oil flow from the twist connector block to the tank. The OPS system requires an unloading valve to function with cabin cranes.

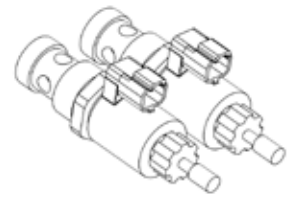

## Lights

Scorpius LED working lights by Nordic Lights are available for KESLA cabins and open control devices. Open control devices and cabins come with two lights as standard. Two additional working lights can also be installed on the outer boom as accessories.



## Emergency stop

The emergency stop switch can be installed on the stabiliser leg beam as an accessory. It can be used to stop the operation of the crane with the press of a button. Operating positions feature an emergency stop switch as standard.

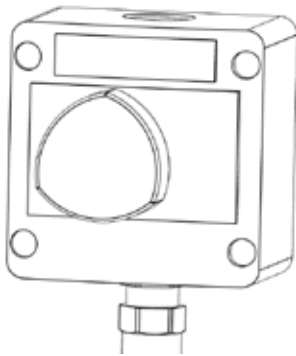

## Lock valve

In Z-cranes, the lock valve keeps the crane in position when it has been detached from the truck.

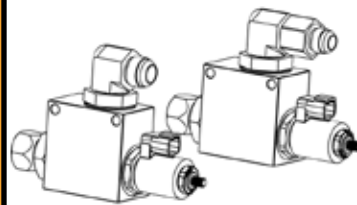

## Dampers

Dampers are available for the lifting and/or rotating functions of KESLA cranes. They smoothen the crane's full motions and reduce the strain impacting the crane.

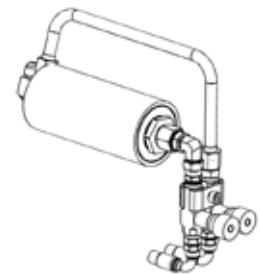

## Lifting cylinder guard

The lifting cylinder guard is an accessory that protects the cylinder against bumps and scratches.



## Log heel

The log heel facilitates the handling of tree-length timber. It can be installed on the lifting boom and, depending on the crane model, on the outer boom.

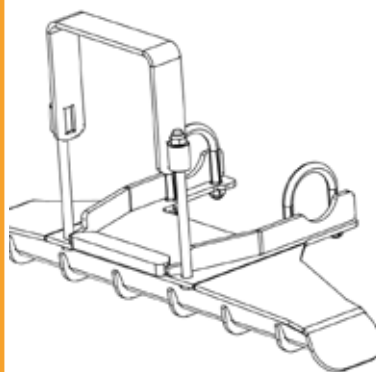

## Central lubrication

Regular lubrication is important to ensure crane operation. With automatic lubrication or centralised lubrication from a single point, lubrication is easy (LINCOLN).

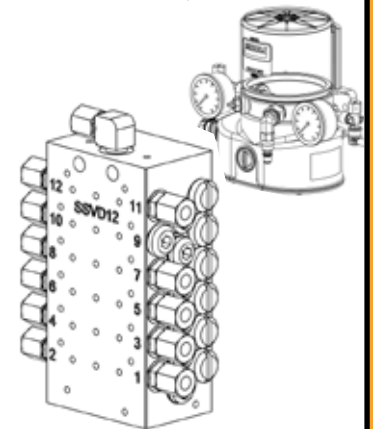

# #yourlifetimematch

Take a look at the video

READ ABOUT OUR OTHER PRODUCT GROUPS:

City cranes - Forest machine cranes - Harvester heads - Chippers - Tractor loaders - Tractor timber trailers

**Kesla Oyj**

Tel. +358 207 862 841  
www.kesla.com

**Headquarters**

Kuurnankatu 24  
FI-80100 JOENSUU

**Kesälahti factory**

Metsolantie 2  
FI-59800 KESÄLAHTI

**Ilomantsi factory**

Teollisuustie 8  
FI-82900 ILOMANTSI

**Find out more!**

