

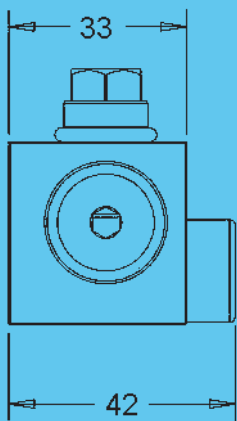

SELECTATEC BAR

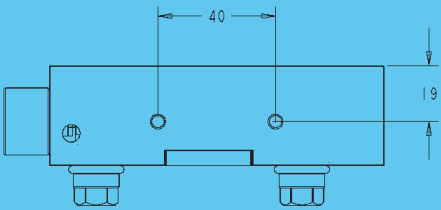
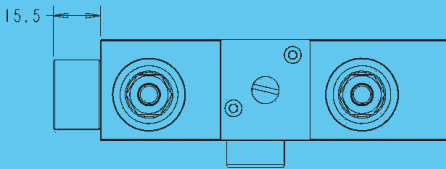
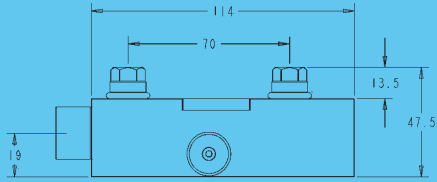

Description

A single station Selectatec Bar, conforming to international standard, used on the anaesthesia machine. This is vaporizer compatible. The anaesthesia vaporizer will be attached on it directly. The input port and output port are horizontal.



Specifications

Sizes (LxWxH)	114x47.5x42 mm
Weight	0.45 Kg
Mixed gases inlet connection	conical connection 23 mm M., ISO DIN 5356/1
Mixed gases outlet connection	conical connection 23 mm F., ISO DIN 5356/1



CM Flowmeters (India) Pvt. Ltd.

Plot 2 Phase III Kasba Industrial Estate EM Bypass Kolkata 700 107 INDIA

Phone : 91 33 2442 1456, 2443 0201 Fax : 91 33 2443 0201

Email : sales@cmflowmeters.in URL : www.cmflowmeters.in