

# TUBE END CLOSURE

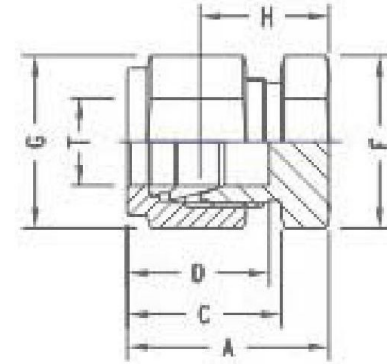

INCH OD Tubes

METRIC OD Tubes

T Tube OD	A	C	D	F A/F	G A/F	H	FITEXCEL PART NO.	T Tube OD	A	C	D	F A/F	G A/F	H	FITEXCEL PART NO.
1/16	13.0	11.0	8.6	11	8	11.2	TEC-773	3	20.1	15.3	12.9	11	11	13.5	TEC-783
1/8	20.0	15.3	12.7	11	11	13.5	TEC-774	6	23.1	17.7	15.3	14	14	15.7	TEC-784
1/4	23.4	17.8	15.3	14	14	16.0	TEC-775	8	24.5	18.6	16.2	16	16	17.0	TEC-785
5/16	24.4	18.5	16.3	16	16	17.0	TEC-776	10	26.6	19.5	17.2	17	19	19.0	TEC-786
3/8	25.7	19.3	16.8	17	17	18.3	TEC-777	12	29.1	22.0	22.8	22	22	19.0	TEC-787
1/2	29.2	21.8	22.9	22	22	19.0	TEC-778	14	29.9	22.0	24.4	24	25	19.8	TEC-788
5/8	30.0	21.8	24.4	24	25	19.8	TEC-779	15	29.9	22.0	24.4	24	25	19.8	TEC-789
3/4	31.5	21.8	24.4	27	28.5	21.4	TEC-780	16	29.9	22.0	24.4	24	25	19.8	TEC-790
7/8	34	21.8	25.9	35	32	23.9	TEC-781	18	31.4	22.0	24.4	27	30	21.3	TEC-791
1	38.4	26.4	31.2	35	38	26.2	TEC-782	20	34.0	22.0	26.0	32	32	23.9	TEC-792
								22	34.0	22.0	26.0	32	32	23.9	TEC-793
								25	38.5	26.5	31.3	35	38	26.2	TEC-794

Dimensions are for reference only and are subject to change without Notice

