

## POSITIONABLE MALE ELBOW

INCH OD Tubes x Male ISO\* parallel Threads

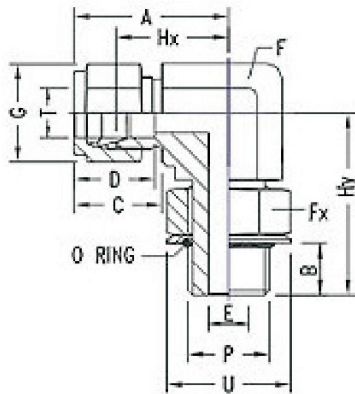

T Tube OD	P ISO Male	Ax	B	C	D	E min.	F	Fx A/F	G A/F	Hx A/F	Hy	U	O Ring Part No.	FITEXCEL PART NO.	
1/4	1/8	27.0	8.2	17.8	15.3	4.0	14	14	14	19.6	26.4	17.3	2 Opn	FPME-624-R	
1/4	1/4	29.0	9.2	17.8	15.3	4.8	16	19	14	21.6	32.3	22.9	4 Opn	FPME-625-R	
3/8	1/4	30.5	9.2	19.3	16.8	5.8	16	19	17	23.2	32.3	22.9	4 Opn	FPME-626-R	
3/8	3/8	33.0	9.2	19.3	16.8	7.1	22	22	17	25.9	37.0	26.4	6 Opn	FPME-627-R	
1/2	1/4	36.0	9.2	21.8	22.9	5.8	22	19	22	25.9	35.0	22.9	4 Opn	FPME-628-R	
1/2	3/8	36.0	9.4	21.8	22.9	7.8	22	22	22	25.9	37.0	26.4	6 Opn	FPME-629-R	
1/2	1/2	38.1	13.0	21.8	24.4	10.4	24	27	22	27.9	43.4	32.0	8 Opn	FPME-630-R	
5/8	1/2	38.1	13.0	21.8	24.4	10.4	24	27	25	27.9	43.4	32.0	8 Opn	FPME-631-R	
3/4	3/4	1/2	39.9	13.0	21.8	24.4	10.4	27	27	28.5	29.7	45.2	32.0	8 Opn	FPME-632-R
		3/4	39.9	13.0	21.8	24.4	15.8	27	35	28.5	29.7	48.8	41.2	12Opn	FPME-633-R
1	3/4	49.0	13.0	26.4	31.2	15.8	35	35	38	36.8	53.3	41.2	12Opn	FPME-634-R	
1	1	49.0	14.0	26.4	31.2	19.8	35	41	38	36.8	53.6	48.5	16Opn	FPME-635-R	



METRIC OD Tubes x Male ISO\* Parallel Threads

T Tube OD	P ISO Male	Ax	B	C	D	E min.	F	Fx A/F	G A/F	Hx A/F	Hy	U	O Ring Part No.	FITEXCEL PART NO.
6	1/8	27.0	8.1	17.7	15.3	4.0	14	14	14	19.6	26.4	17.3	2 Opn	FPME-636-R
6	1/4	29.0	9.1	17.7	15.3	4.8	16	19	14	21.6	32.3	22.9	4 Opn	FPME-637-R
8	1/8	28.8	8.1	18.6	16.2	4.0	14	14	16	21.3	27.4	17.3	2 Opn	FPME-638-R
8	1/4	29.9	9.1	18.6	16.2	5.9	16	19	16	22.4	32.2	22.9	4 Opn	FPME-639-R
10	1/4	33.5	9.1	19.5	17.2	5.9	19	19	19	25.9	35.0	22.9	4 Opn	FPME-640-R
10	3/8	33.5	9.4	19.5	17.2	7.9	19	22	19	25.9	37.1	26.4	6 Opn	FPME-641-R
12	3/8	36.0	9.4	22.0	22.8	7.9	22	22	22	25.9	37.1	26.4	6 Opn	FPME-642-R
12	1/2	38.0	13.0	22.0	22.8	9.5	24	27	22	27.9	43.4	32.0	8 Opn	FPME-643-R
12	3/4	39.8	13.0	22.0	22.8	9.5	27	35	22	29.7	48.8	41.1	Opn	FPME-644-R

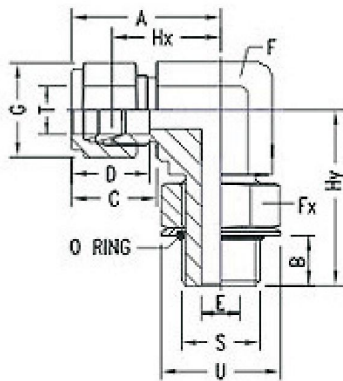

INCH OD Tube x SAE/MS Straight Thread

T Tube OD	P ISO Male	Ax	B	C	D	E	F	Fx	G A/F	Hx	Hy	U	O Ring Part No.	FITEXCEL PART NO.
1/4	7/16-20	28.5	9.9	17.8	15.3	4.8	14	14	14	21.0	28.5	16.5	4 OPU	FPME-645-U
1/4	9/16-18	30.5	11.2	17.8	15.3	4.8	16	17	14	23.1	32.3	20.0	6 OPU	FPME-646-U
3/8	9/16-18	32.0	11.2	19.3	16.8	7.1	16	17	17	24.6	32.3	20.0	6 OPU	FPME-647-U
3/8	3/4-6	34.8	12.7	19.3	16.8	7.1	22	22	17	27.4	37.8	25.6	8 OPU	FPME-648-U
1/2	3/4-16	37.6	12.7	21.8	22.9	10.4	22	22	22	27.4	37.8	25.6	8 OPU	FPME-649-U
5/8	7/16-14	39.6	14.3	21.8	24.4	12.7	24	25	25	29.5	43.4	29.5	10OPU	FPME-650-U
3/4	11/16-12	41.4	16.8	21.8	24.4	15.8	27	32	28.5	31.2	48.8	36.6	12OPU	FPME-651-U
7/8	11/16-12	43.2	16.8	21.8	25.9	18.3	30	32	32	33	50.5	40.4	14OPU	FPME-652-U
1	15/16-12	50.5	16.8	26.4	31.2	22.3	35	35	38	38.4	53.6	44.0	16OPU	FPME-653-U