

# POSITIONABLE MALE BRANCH TEE

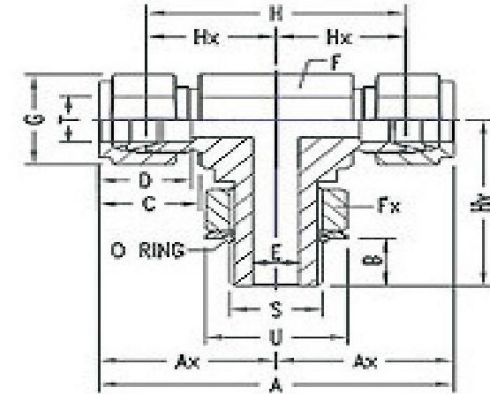

## INCH OD Tubes x SAE/MS \*Straight threads

T Tube OD	S SAE/MS Male	A	Ax	B	C	D	E min.	F A/F	Fx A/F	G A/F	H	Hx	Hy	U	O Ring Part No.	FITEXCEL PART NO.
1/4	7/16-20	57.0	28.5	9.9	17.8	15.3	4.8	14	14	14	42.0	21.0	28.5	16.5	4 OPU	PMBT-654-R
3/8	9/16-18	64.3	32.0	11.2	19.3	16.8	7.1	16	17	17	49.2	24.6	32.3	20.0	6 OPU	PMBT-655-R
1/2	3/4-16	75.4	37.6	12.7	21.8	22.9	10.4	22	22	22	54.8	27.4	37.8	25.6	8 OPU	PMBT-656-R
3/4	11/16-12	90.2	41.4	16.8	21.8	24.4	15.8	27	32	28.5	62.4	31.2	48.8	36.6	12 OPU	PMBT-657-R
1	15/16-12	104.1	50.5	16.8	26.4	31.2	22.3	35	35	38	76.8	38.4	53.6	44.0	16 OPU	PMBT-658-R

## METRIC OD Tubes x SAE/MS \*Straight threads

T Tube OD	S SAE/MS Male	A	Ax	B	C	D	E min.	F A/F	Fx A/F	G A/F	H	Hx	Hy	U	O Ring Part No.	FITEXCEL PART NO.
6	7/16-20	57.0	28.5	9.9	17.7	15.3	4.8	14	14	14	42.0	21.0	28.5	16.5	4 OPU	PMBT-659-R
10	9/16-18	64.3	32.0	11.2	19.5	17.2	7.1	16	17	17	49.2	24.6	32.3	20.0	6 OPU	PMBT-660-R
12	3/4-16	75.4	37.6	12.7	22.0	22.8	10.4	22	22	22	54.8	27.4	37.8	25.6	8 OPU	PMBT-661-R

Dimensions are for reference only and are subject to change without Notice