

# FEMALE ELBOW

## INCH OD Tubes x Female NPT Threads

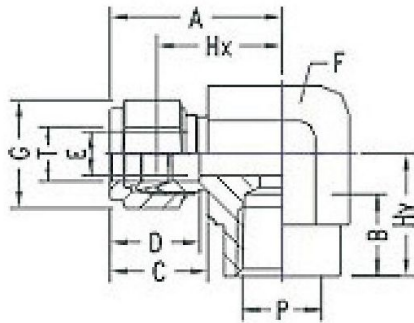

| T Tube OD | P NPT Female | A    | B    | C    | D    | E min. | F A/F | G A/F | H    | Hy   | FITEXCEL PART NO. |
|-----------|--------------|------|------|------|------|--------|-------|-------|------|------|-------------------|
| 1/8       | 1/8          | 24.6 | 10.4 | 15.3 | 12.7 | 2.4    | 14    | 11    | 18.0 | 19.0 | FFE-381-N         |
| 1/8       | 1/4          | 27.4 | 15.0 | 15.3 | 12.7 | 2.4    | 19    | 11    | 20.8 | 22.4 | FFE-382-N         |
| 1/4       | 1/8          | 26.9 | 10.4 | 17.8 | 15.3 | 4.8    | 14    | 14    | 19.6 | 19.0 | FFE-383-N         |
| 1/4       | 1/4          | 29.7 | 15.0 | 17.8 | 15.3 | 4.8    | 19    | 14    | 22.4 | 22.4 | FFE-384-N         |
| 1/4       | 3/8          | 31.8 | 15.0 | 17.8 | 15.3 | 4.8    | 22    | 14    | 24.4 | 22.4 | FFE-385-N         |
| 1/4       | 1/2          | 34.6 | 19.8 | 17.8 | 15.3 | 4.8    | 27    | 14    | 27.2 | 28.5 | FFE-386-N         |
| 5/16      | 1/8          | 28.7 | 10.4 | 17.8 | 15.3 | 6.3    | 19    | 14    | 21.4 | 19.1 | FFE-387-N         |
| 5/16      | 1/4          | 30.5 | 15.0 | 18.5 | 16.3 | 6.3    | 22    | 16    | 23.2 | 22.4 | FFE-388-N         |
| 3/8       | 1/8          | 30.5 | 10.4 | 19.3 | 16.8 | 7.1    | 17    | 17    | 23.2 | 19.1 | FFE-389-N         |
| 3/8       | 1/4          | 31.2 | 15.0 | 19.3 | 16.8 | 7.1    | 19    | 17    | 23.9 | 22.4 | FFE-390-N         |
| 3/8       | 3/8          | 33.3 | 15.0 | 19.3 | 16.8 | 7.1    | 22    | 17    | 25.9 | 22.4 | FFE-391-N         |
| 3/8       | 1/2          | 36.0 | 19.8 | 19.3 | 16.8 | 7.1    | 27    | 17    | 28.7 | 28.5 | FFE-392-N         |
| 1/2       | 1/4          | 36.0 | 15.0 | 21.8 | 22.9 | 7.1    | 22    | 22    | 25.9 | 22.4 | FFE-393-N         |
| 1/2       | 3/8          | 36.0 | 15.0 | 21.8 | 22.9 | 10.4   | 22    | 22    | 25.9 | 22.4 | FFE-394-N         |
| 1/2       | 1/2          | 38.9 | 19.8 | 21.8 | 22.9 | 10.4   | 27    | 22    | 28.7 | 28.5 | FFE-395-N         |
| 5/8       | 3/8          | 38.1 | 15.0 | 21.8 | 22.9 | 12.7   | 24    | 22    | 28.0 | 22.4 | FFE-396-N         |
| 5/8       | 1/2          | 39.9 | 19.8 | 21.8 | 24.4 | 12.7   | 27    | 25    | 29.7 | 28.5 | FFE-397-N         |
| 3/4       | 1/2          | 39.9 | 19.8 | 21.8 | 24.4 | 15.8   | 27    | 28.5  | 29.7 | 28.5 | FFE-398-N         |
| 3/4       | 3/4          | 44.7 | 20.6 | 21.8 | 24.4 | 15.8   | 35    | 28.5  | 34.6 | 31.8 | FFE-399-N         |
| 7/8       | 3/4          | 44.7 | 20.6 | 21.8 | 25.9 | 18.2   | 35    | 32    | 34.6 | 31.8 | FFE-400-N         |
| 1         | 3/4          | 49.0 | 20.6 | 26.4 | 31.2 | 22.3   | 35    | 38    | 36.8 | 31.8 | FFE-401-N         |
| 1         | 1            | 53.6 | 25.4 | 26.4 | 31.2 | 22.3   | 41    | 38    | 41.4 | 38.1 | FFE-402-N         |

## METRIC OD Tubes x Female NPT Threads

| T Tube OD | P NPT Female | A    | B    | C    | D    | E min | F A/F | G A/F | H <sub>z</sub> | Hy   | FITEXCEL PART NO. |
|-----------|--------------|------|------|------|------|-------|-------|-------|----------------|------|-------------------|
| 3         | 1/8          | 24.6 | 10.4 | 15.3 | 12.9 | 2.4   | 14    | 11    | 18.0           | 19.0 | FFE-403-N         |
| 3         | 1/4          | 27.4 | 15.0 | 15.3 | 12.9 | 2.4   | 19    | 11    | 20.8           | 22.4 | FFE-404-N         |
| 6         | 1/8          | 27.0 | 10.4 | 17.7 | 15.3 | 4.8   | 14    | 14    | 19.6           | 19.0 | FFE-405-N         |
| 6         | 1/4          | 29.8 | 15.0 | 17.7 | 15.3 | 4.8   | 19    | 14    | 22.4           | 22.4 | FFE-406-N         |
| 6         | 1/2          | 34.6 | 19.8 | 17.7 | 15.3 | 4.8   | 27    | 14    | 7.2            | 28.5 | FFE-408-N         |
| 8         | 1/4          | 30.6 | 15.0 | 18.6 | 16.2 | 6.3   | 19    | 16    | 23.1           | 22.4 | FFE-409-N         |
| 8         | 3/8          | 32.6 | 15.0 | 18.6 | 16.2 | 6.3   | 22    | 16    | 25.1           | 22.4 | FFE-410-N         |
| 10        | 1/4          | 33.5 | 15.0 | 19.5 | 17.2 | 7.9   | 19    | 19    | 25.9           | 22.4 | FFE-411-N         |
| 10        | 3/8          | 33.5 | 15.0 | 19.5 | 17.2 | 7.9   | 22    | 19    | 25.9           | 22.4 | FFE-412-N         |
| 12        | 1/4          | 36.0 | 15.0 | 22.0 | 22.8 | 9.5   | 22    | 22    | 25.9           | 22.4 | FFE-413-N         |
| 12        | 3/8          | 36.0 | 15.0 | 22.0 | 22.8 | 9.5   | 22    | 22    | 25.9           | 22.4 | FFE-414-N         |
| 12        | 1/2          | 38.8 | 19.8 | 22.0 | 22.8 | 9.5   | 27    | 22    | 28.7           | 28.5 | FFE-415-N         |
| 16        | 1/2          | 39.5 | 19.8 | 22.0 | 24.4 | 12.7  | 27    | 25    | 29.7           | 28.5 | FFE-416-N         |