

**PULL ACTION CLAMP
LATCH TYPE
HORIZONTAL**

Pull Action Clamps are Latch type clamps used for sealing chambers, lids, doors of moulds, drums, containers or other vessels etc. Also suitable for clamping moulds in industries such as resin, fibre glass, chemicals & food.

'P-TECH' Pull Action clamp has a unique design which enables use of same clamp as a horizontal pull action clamp as shown.

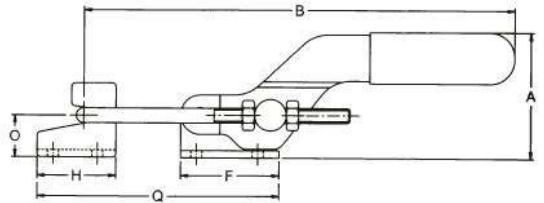
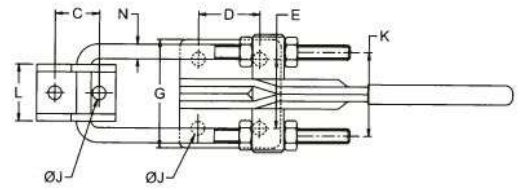

| ITEM CODE | MODELS | HOLDING CAPACITY | WEIGHT | DRAWING MOVEMENT | DIMENSIONS | | | | | | | | | | | | | | |
|-----------|-----------|------------------|--------|------------------|------------|-----|----|-------|-------|----|----|----|------|----|----|----|------|--------|-------|
| | | | | | A | B | C | D | E | F | G | H | J | K | L | N | O | Q Min. | Q Max |
| I3401 | PPAC-4-H | 100 kgs | 0.100 | 46.0 | 29 | 120 | 11 | 16 | 20 | 26 | 30 | 20 | 4.5 | 21 | 15 | 4 | 12 | 47.0 | 59.4 |
| I3402 | PPAC-5-H | 200 kgs | 0.220 | 44.0 | 45 | 162 | 11 | 20 | 32 | 35 | 45 | 25 | 6.5 | 28 | 19 | 5 | 15 | 65.0 | 80.0 |
| I3403 | PPAC-6-H | 350 kgs | 0.350 | 50.0 | 50 | 190 | 18 | 25 | 28 | 40 | 45 | 32 | 6.5 | 34 | 23 | 6 | 16.5 | 105 | 140 |
| I3404 | PPAC-8-H | 950 kgs | 0.900 | 88.0 | 61 | 240 | 22 | 40 | 42 | 60 | 60 | 40 | 8.2 | 47 | 60 | 8 | 23.5 | 130 | 170 |
| I3405 | PPAC-11-H | 3000 kgs | 2.250 | 89.0 | 93 | 245 | 35 | 57.15 | 57.15 | 85 | 80 | 55 | 10.2 | 48 | 80 | 11 | 31.5 | 143 | 175 |