



DIAPHRAGM LEVEL SENSOR(JAYCEEBOOT)

PRINCIPAL

The device must be mounted so that the diaphragm membrane is exposed to the product whose level should be controlled, in such a way that the product can press the diaphragm. The material weight presses the diaphragm which is adjusted with the micro switch through a flexible mechanism. A liver attached to the diaphragm transfers the pressure to the micro switch which changes the contact. When the material recedes the diaphragm comes back to its normal position and the micro switch again changes the contact.

Features

The JAYCEEBOOT consists of a micro switch inside a cast Al housing , covered by a flexible Diaphragm.

Applications

The JAYCEEBOOT level switch is used for indicating, controlling, and regulating the level of granulated or powdered dry materials with a grain diameter up to 30 mm and a density of 0,3 to 2,5 g/cm³, flowing through a silo, hopper or chute.

Technical Specification

Normal sensitivity	: 200 gm(Rubber) / 400 gm(SS)
Diaphragm Membrane material	: Nitrial Rubber / SS
Ambient temperature	: 60 Deg Micro switch
contacts	: 15 Amp, 230 V AC, Potential free
Cable Gland	: PG 11
Main body	: Cast Aluminium
Switching Housing	: Polymer for SS type

Parts

The parts of DIAPHRAGM are explained in figure

1. All dimensions are in millimeters.

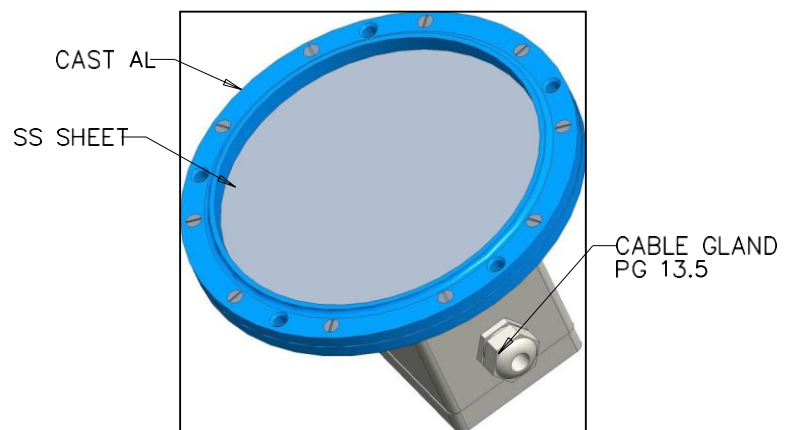
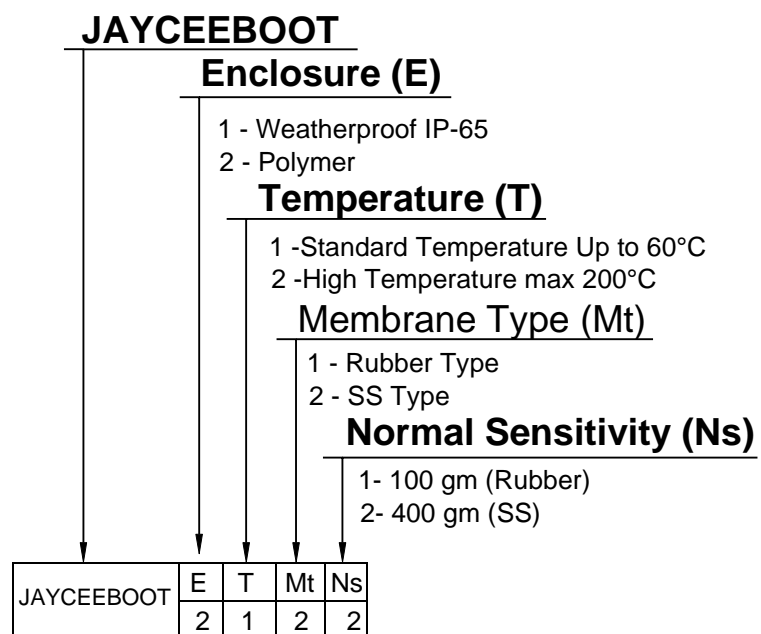

Figure 1 : Diaphragm

Model Selection



JAYCEE TECHNOLOGIES PVT. LTD.

An ISO 9001-2008 C E Certified Company
 Shed No. 7, Nanekar Industries Building, Survey No. 79/2,
 Dangat Industrial Estate, Shivane, Pune - 411 023, India
 Contact No. : 07447401743
 Email : jayceetech@gmail.com Website : WWW.jayceetech.com