

## **SANDEEP TWO HEAD MULTI BORING MACHINE**

---

**MODEL MZ 7221A**

---





## **SALIENT FEATURES:**

---

1. *Button control; ensure high reliability and easy functioning.*
2. *Suitable for almost all panel materials of wood or plastic .*
3. *Cast- steel body, stable and durable.*

4. *Positioning cylinder; ensure working stability.*

5. *Two Rows Boring Machine for cabinet combine one horizontal and one vertical boring units to*

*enhance working accuracy and reduce your production time.*

6. *The mechanical switch provides convenient and accurate adjustment for boring depth &*

*Position.*

7. *The moving head can be rotated from parallel to perpendicular i.e. 0°-90°*

8. *Accuracy  $\pm 0.2\text{mm}$*

9. *6 Nos. Collets are provided with each drilling head along with Tool Box Manual & required tools.*

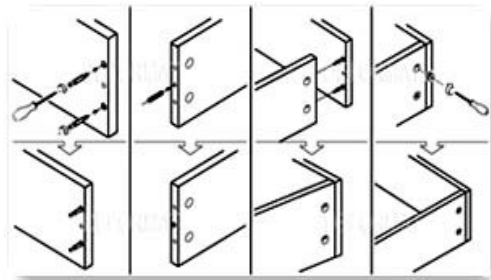



• **Maximum Center Distance Between Holes**      **L Max. x W Max. = 1350mm x 640mm**

• **Minimum Center Distance Between Holes**      **L Min. x W Min. = 135mm x 32mm**

• **Total Number of Drilling Spindles**      **21 x 2 = 42**

• **Installation Pitch of Drilling Head**      **10mm**

- **Moveable Scope of vertical Drill** **1000mm**

- **Spindle Speed** **2800 rpm**

- **Air Pressure** **0.5~0.6mpa**

- **Total Motor Power** **3 KW**



- Weight 600 Kg

- Overall Dimensions 2000 x 2500 x 1450mm

[https://www.youtube.com/watch?v=2IEudl\\_INJI&feature=youtu.be](https://www.youtube.com/watch?v=2IEudl_INJI&feature=youtu.be)



Horizontal drilling height regulator



Positioning Cylinder



Button controlling platform



Electrical box



Tool box



Lubricating system

